



Recreation Window And Door
Bringing The Outside In



WINDOWS & DOORS



CASEMENT

WINDOWS



Picture windows

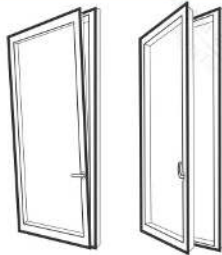

Tilt turn windows



Hopper windows



Out swing windows

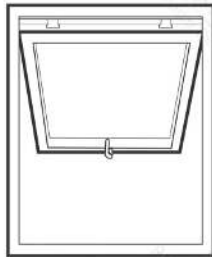

Top hung windows

We all know how important windows are to the look of a home and with The Puertana Contemporary Living Collection, it's never been easier to get these right.

With so many types – inward-opening, outward-opening, side-hung, top-hung, tilt-turn or fixed light – there'll always be a window to meet your needs. And it will offer excellent 'U' values, a smooth operation and tight, draught proof weather-seals.



55 series

Non-thermal break aluminum casement window & door

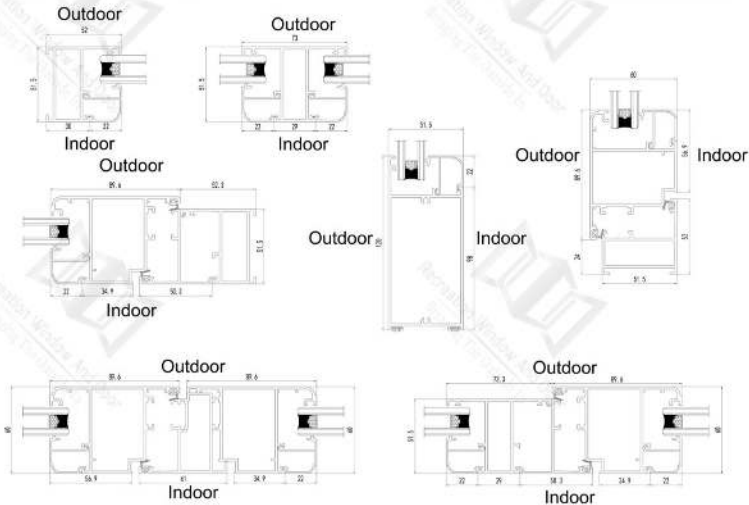

GENERAL SPECIFICATIONS

- Profile thickness: 1.7mm
- Double glazed glass
- Color powder coating
- Radius tops and arches available
- Anodized aluminum



55 series

Non-thermal break aluminum casement window & door

PERFORMANCE

DESCRIPTION	VALUE	DESCRIPTION	VALUE
SHGC	0.14-0.97	U-Value (BTU/h-ft ² ·°F)	0.24-0.6
Air Infiltration (cfm/ft ²)	0.01	STC (dB)	35
Water resistance (psf)	12.11	VT	0.13-0.85

*Values may vary depending on glazing packages utilized

OPTIONS

- Possibility of incorporating hardware with concealed hinges
- Multiple glazing packages and finish options
- Dual-sealed warm edge spacer
- Mosquito screens available
- argon gas infill

STANDARD FEATURES

- Opening: side hung and top hung of 1 or 2 sashes
- Sections:
 - Frame: 52mm
 - Sash: 60mm
- Maximum dimensions/sash:
 - Width up to 1,500mm
 - Height up to 3,500mm
- Max weight/sash: 300 kg
- Multipoint locking hardware
- Maximum glazing thickness: 22mm



65 series

Thermal break aluminum casement window

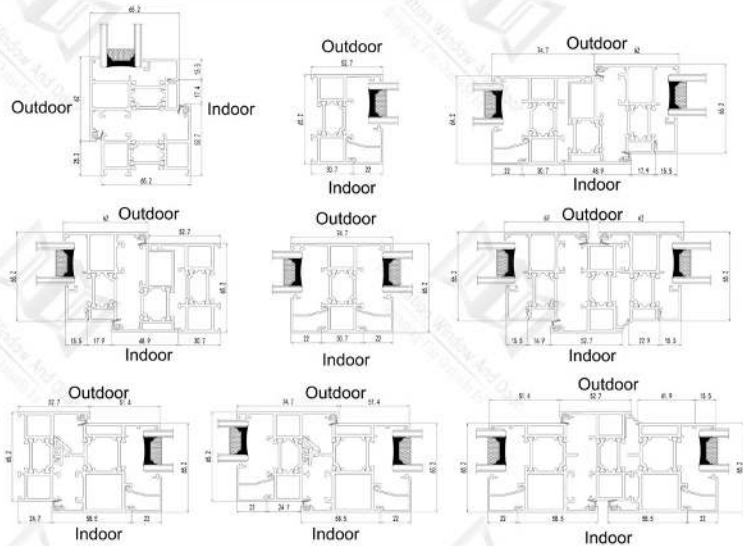

GENERAL SPECIFICATIONS

- Profile thickness: 2.0mm
- Double glazed glass
- Radius tops and arches available
- Possibility of dual color
- Color powder coating



65 series

Thermal break aluminum casement window

PERFORMANCE

DESCRIPTION	VALUE	DESCRIPTION	VALUE
SHGC	0.14-0.97	U-Value (BTU/h-ft ² ·°F)	0.24-0.6
Air Infiltration (cfm/ft ²)	0.01	STC (dB)	41
Water resistance (psf)	12.11	VT	0.13-0.85

*Values may vary depending on glazing packages utilized

OPTIONS

- Possibility of incorporating hardware with concealed hinges
- Multiple glazing packages and finish options
- Mosquito screens available
- Dual-sealed warm edge spacer
- argon gas infill

STANDARD FEATURES

- Opening: tilt and turn, side hung and top hung of 1 or 2 sashes
- Sections:
 - Frame: 65mm
 - Sash: 65mm
- Maximum dimensions/sash:
 - Width up to 1,500mm
 - Height up to 3,500mm
- Max weight/sash: 300 kg
- Multipoint locking hardware
- Maximum glazing thickness: 32mm



75 series

Thermal break aluminum casement window

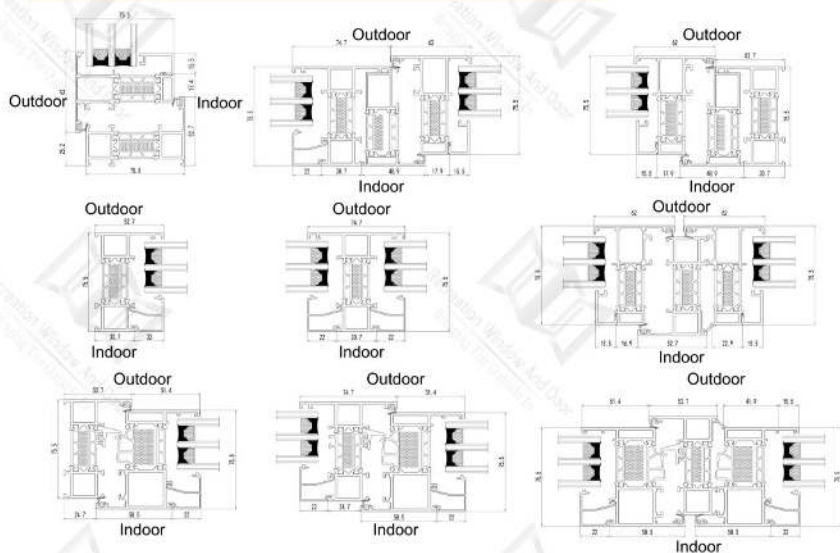

GENERAL SPECIFICATIONS

- Profile thickness: 2.0mm
- Triple glazed glass
- Radius tops and arches available
- Possibility of dual color
- Color powder coating



75 series

Thermal break aluminum casement window

PERFORMANCE

DESCRIPTION	VALUE	DESCRIPTION	VALUE
SHGC	0.14-0.97	U-Value (BTU/h-ft ² ·°F)	0.24-0.6
Air Infiltration (cfm/ft ²)	0.01	STC (dB)	45
Water resistance (psf)	12.11	VT	0.13-0.85

*Values may vary depending on glazing packages utilized

OPTIONS

- Possibility of incorporating hardware with concealed hinges
- Multiple glazing packages and finish options
- Mosquito screens available
- Dual-sealed warm edge spacer
- argon gas infill

STANDARD FEATURES

- Opening: tilt and turn, side hung and top hung of 1 or 2 sashes
- Sections:
 - Frame: 75mm
 - Sash: 75mm
- Maximum dimensions/sash:
 - Width up to 1,500mm
 - Height up to 3,500mm
- Max weight/sash: 300 kg
- Multipoint locking hardware
- Maximum glazing thickness: 41mm



108 series

Thermal break aluminum casement window

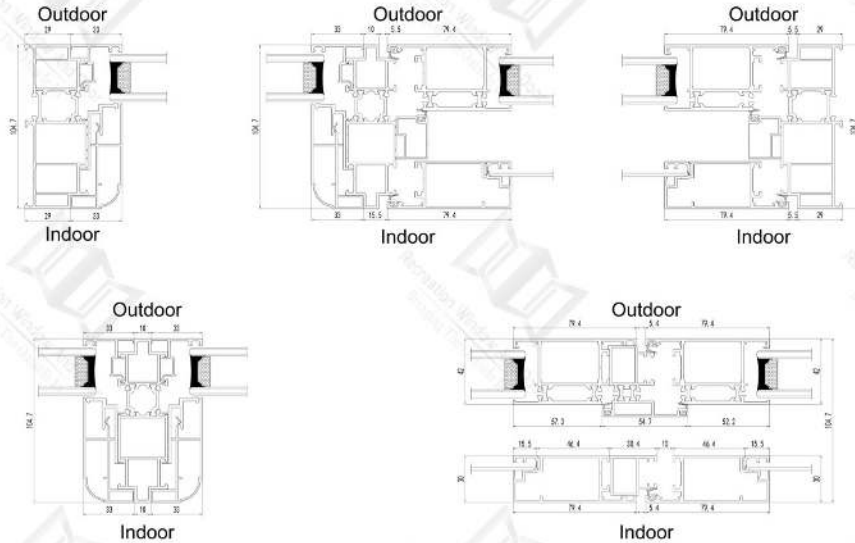

GENERAL SPECIFICATIONS

- Profile thickness: 1.6mm
- Double glazed glass
- Stainless steel wire mesh
- Radius tops and arches available
- Possibility of dual color
- Color powder coating



108 series

Thermal break aluminum casement window

PERFORMANCE

DESCRIPTION	VALUE	DESCRIPTION	VALUE
SHGC	0.14-0.97	U-Value (BTU/h-ft ² ·°F)	0.24-0.6
Air Infiltration (cfm/ft ²)	0.01	STC (dB)	38
Water resistance (psf)	12.11	VT	0.13-0.85

*Values may vary depending on glazing packages utilized

OPTIONS

- Possibility of incorporating hardware with concealed hinges
- Multiple glazing packages and finish options
- Mosquito screens available
- Dual-sealed warm edge spacer
- argon gas infill

STANDARD FEATURES

- Opening: side hung and top hung of 1 or 2 sashes
- Sections:
 - Frame: 108mm
 - Sash: 42mm
- Maximum dimensions/sash:
 - Width up to 1,200mm
 - Height up to 2,400mm
- Max weight/sash: 160 kg
- Multipoint locking hardware
- Maximum glazing thickness: 31mm



Flip out

108 series thermal break aluminum gas strut window

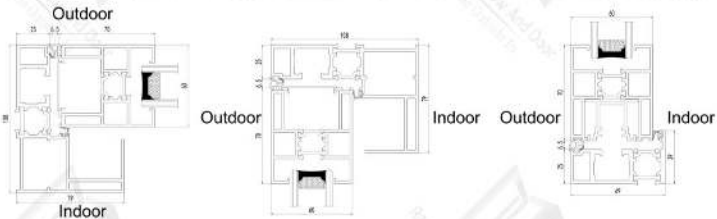

GENERAL SPECIFICATIONS

- profile thickness: 2.0mm
- double glazed glass
- possibility of dual color
- color powder coating



Flip out

108 series thermal break aluminum gas strut window

PERFORMANCE

DESCRIPTION	VALUE	DESCRIPTION	VALUE
SHGC	0.14-0.97	U-Value (BTU/h-ft ² ·°F)	0.24-0.6
Air Infiltration (cfm/ft ²)	0.01	STC (dB)	38
Water resistance (psf)	12.11	VT	0.13-0.85

*Values may vary depending on glazing packages utilized

OPTIONS

- Multiple glazing packages and finish options
- Mosquito screens available
- Dual-sealed warm edge spacer
- argon gas infill

STANDARD FEATURES

- Opening: top hung of 1 sash
- Sections:
 - Frame: 108mm
 - Sash: 60mm
- Maximum dimensions/sash:
 - Width up to 3000mm
 - Height up to 1800mm
- Max weight/sash: 200 kg
- Multipoint locking hardware
- Maximum glazing thickness: 32mm



60 series

Steel look thermal break aluminum Casement window door

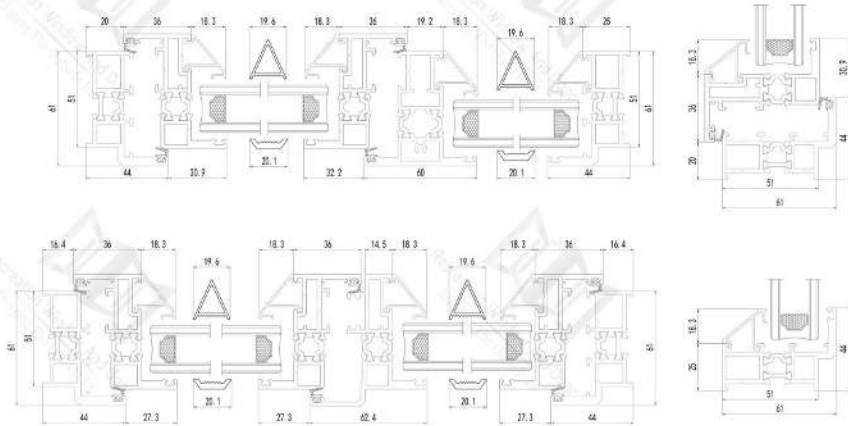

STANDARD FEATURES

- Opening: side hung of 1 or 2 sashes
- Sections:
 - Frame: 61mm
 - Sash: 54mm
- Maximum dimensions/sash:
 - Width up to 1,200mm
 - Height up to 2,500mm
- Max weight/sash: 150 kg
- Multipoint locking hardware
- Maximum glazing thickness: 25mm
- Both sides with grids attached outside of glass



60 series

Steel look thermal break aluminum casement window door



PERFORMANCE

DESCRIPTION	VALUE	DESCRIPTION	VALUE
SHGC	0.14-0.97	U-Value (BTU/h-ft ² ·°F)	0.24-0.6
Air Infiltration (cfm/ft ²)	0.01	STC (dB)	45
Water resistance (psf)	12.11	VT	0.13-0.85

*Values may vary depending on glazing packages utilized

GENERAL SPECIFICATIONS

- Profile thickness: 2.0mm
- Double glazed glass
- Radius tops and arches available
- Possibility of dual color
- Color powder coating

OPTIONS

- Multiple glazing packages and finish options
- Mosquito screens available
- Dual-sealed warm edge spacer
- Argon gas infill

80/120 series

Non-thermal break aluminum sliding window

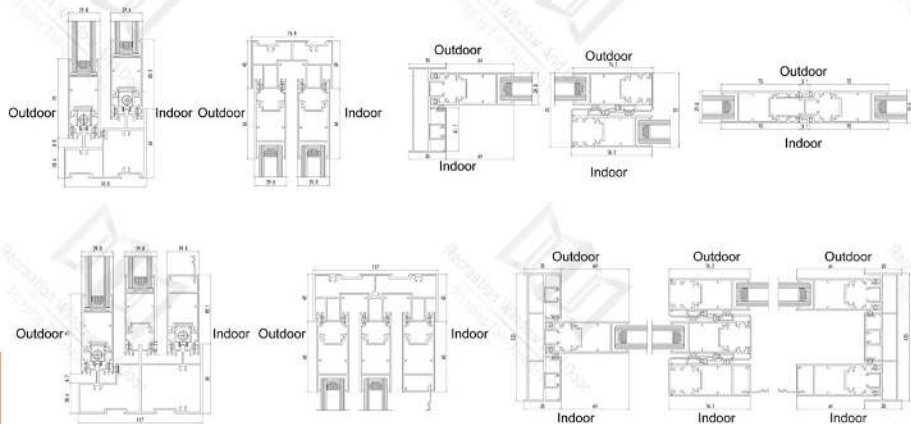

GENERAL SPECIFICATIONS

- Profile thickness: 1.4mm
- Double glazed glass
- Stainless steel wire mesh
- Possibility of 3 Rails
- Color powder coating



80/120 series

Non-thermal break aluminum sliding window

PERFORMANCE

DESCRIPTION	VALUE	DESCRIPTION	VALUE
SHGC	0.14-0.97	U-Value (BTU/h-ft ² ·°F)	0.24-0.6
Air Infiltration (cfm/ft ²)	0.01	STC (dB)	33
Water resistance (psf)	12.11	VT	0.13-0.85

*Values may vary depending on glazing packages utilized

OPTIONS

- Multiple glazing packages and finish options
- Dual-sealed warm edge spacer
- argon gas infill

STANDARD FEATURES

- Sliding of 2, 3, 4 & 6 Sashes
- Sections:
 - Frame: 77mm / 117mm
 - Sash: 30mm
- Maximum dimensions/sash:
 - Width up to 1,200mm
 - Height up to 2,400mm
- Max weight/sash: 160 kg
- Multipoint locking hardware
- Maximum glazing thickness: 22mm



120 series

Thermal break aluminum sliding window

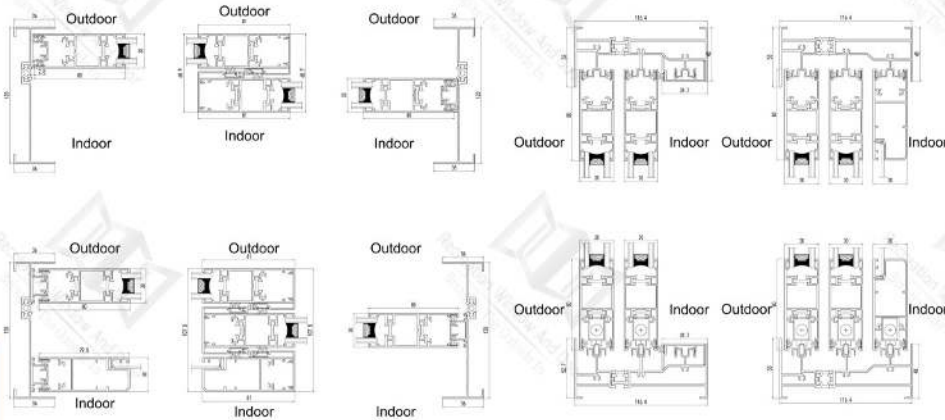

GENERAL SPECIFICATIONS

- Profile thickness: 1.7mm
- Double glazed glass
- Possibility of dual color
- Color powder coating
- Stainless steel wire mesh
- Possibility of 3 Rails



120 series

Thermal break aluminum sliding window

PERFORMANCE

DESCRIPTION	VALUE	DESCRIPTION	VALUE
SHGC	0.14-0.97	U-Value (BTU/h·ft ² ·°F)	0.24-0.6
Air Infiltration (cfm/ft ²)	0.01	STC (dB)	35
Water resistance (psf)	12.11	VT	0.13-0.85

*Values may vary depending on glazing packages utilized

OPTIONS

- Multiple glazing packages and finish options
- Dual-sealed warm edge spacer
- argon gas infill

STANDARD FEATURES

- Sliding of 2, 3, 4 & 6 Sashes
- Sections:
 - Frame: 120mm
 - Sash: 30mm
- Maximum dimensions/sash:
 - Width up to 1,500mm
 - Height up to 2,000mm
- Max weight/sash: 160 kg
- Multipoint locking hardware
- Maximum glazing thickness: 22mm



50 series

Non-thermal break single hung window

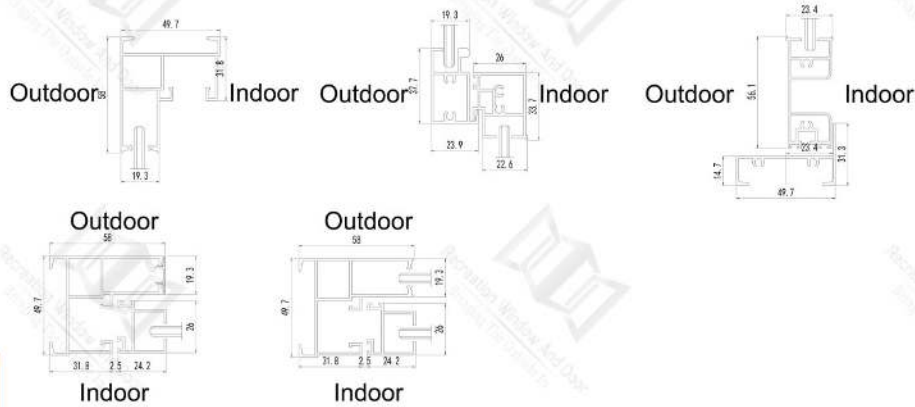

GENERAL SPECIFICATIONS

- profile thickness: 1.4mm
- Single glazed glass
- color powder coating

STANDARD FEATURES

- Opening: single of 1 sash
- Sections: - Frame: 50mm - Sash: 26mm
- Maximum dimensions/sash:
 - Width up to 1,200mm
 - Height up to 2,400mm
- Max weight/sash: 160 kg
- Multipoint locking hardware
- Maximum glazing thickness: 22mm



50 series

Non-thermal break single hung window



PERFORMANCE

DESCRIPTION	VALUE	DESCRIPTION	VALUE
SHGC	0.14-0.97	U-Value (BTU/h·ft²·°F)	0.24-0.6
Air Infiltration (cfm/ft²)	0.01	STC (dB)	30
Water resistance (psf)	12.11	VT	0.13-0.85

*Values may vary depending on glazing packages utilized

OPTIONS

- Multiple glazing packages and finish options
- Mosquito screens available

70 series

Non-thermal break aluminum single hung window

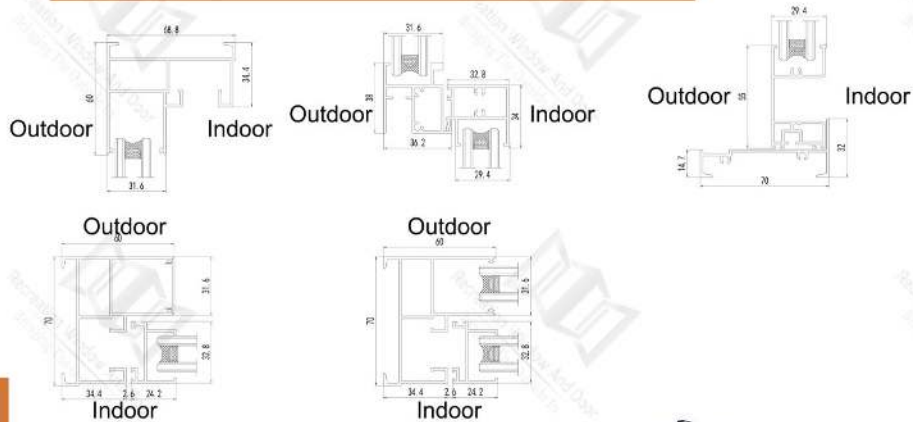

GENERAL SPECIFICATIONS

- profile thickness: 1.4mm
- Single glazed glass
- color powder coating

OPTIONS

- Multiple glazing packages and finish options
- Mosquito screens available

70 series

Non-thermal break aluminum single hung window

PERFORMANCE

DESCRIPTION	VALUE	DESCRIPTION	VALUE
SHGC	0.14-0.97	U-Value (BTU/h-ft ² ·°F)	0.24-0.6
Air Infiltration (cfm/ft ²)	0.01	STC (dB)	35
Water resistance (psf)	12.11	VT	0.13-0.85

*Values may vary depending on glazing packages utilized

STANDARD FEATURES

- Opening: single of 1 sash
- Sections: - Frame: 50mm - Sash: 26mm
- Maximum dimensions/sash:
 - Width up to 1,200mm
 - Height up to 2,400mm
- Max weight/sash: 160 kg
- Multipoint locking hardware
- Maximum glazing thickness: 22mm



83 series

Non-thermal break aluminum double hung window

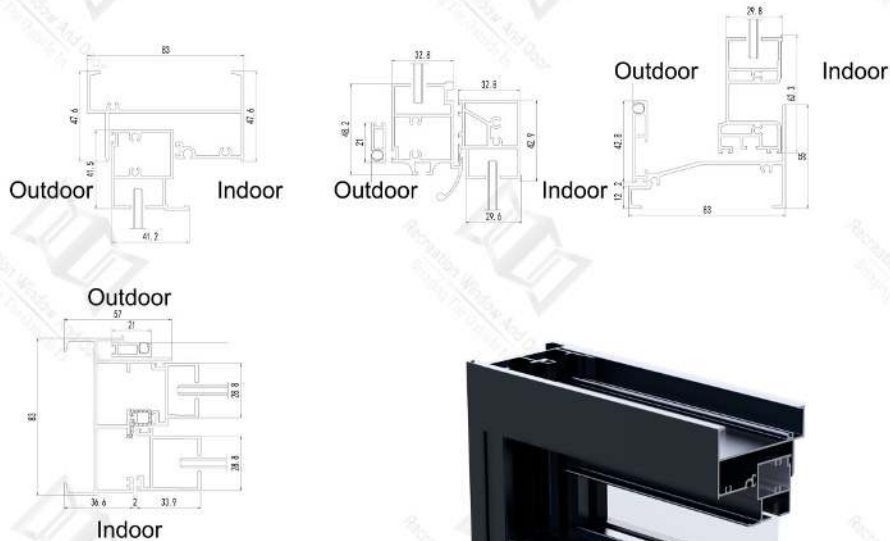

GENERAL SPECIFICATIONS

- profile thickness: 1.4mm
- Single glazed glass
- color powder coating

OPTIONS

- Multiple glazing packages and finish options
- Mosquito screens available

83 series

Non-thermal break aluminum double hung window

PERFORMANCE

DESCRIPTION	VALUE	DESCRIPTION	VALUE
SHGC	0.14-0.97	U-Value (BTU/h·ft²·°F)	0.24-0.6
Air Infiltration (cfm/ft²)	0.01	STC (dB)	38
Water resistance (psf)	12.11	VT	0.13-0.85

*Values may vary depending on glazing packages utilized

STANDARD FEATURES

- Opening: single of 1 sash
- Sections: - Frame: 50mm - Sash: 26mm
- Maximum dimensions/sash:
 - Width up to 1,200mm
 - Height up to 2,400mm
- Max weight/sash: 160 kg
- Multipoint locking hardware
- Maximum glazing thickness: 22mm



83 series

Thermal break aluminum double hung window



GENERAL SPECIFICATIONS

- profile thickness: 1.4mm
- Single glazed glass
- color powder coating

OPTIONS

- Multiple glazing packages and finish options
- Mosquito screens available



83 series

Thermal break aluminum double hung window

PERFORMANCE

DESCRIPTION	VALUE	DESCRIPTION	VALUE
SHGC	0.14-0.97	U-Value (BTU/h·ft ² ·°F)	0.24-0.6
Air Infiltration (cfm/ft ²)	0.01	STC (dB)	41
Water resistance (psf)	12.11	VT	0.13-0.85

*Values may vary depending on glazing packages utilized

STANDARD FEATURES

- Opening: single of 1 sash
- Sections: - Frame: 50mm - Sash: 26mm
- Maximum dimensions/sash:
 - Width up to 1,200mm
 - Height up to 2,400mm
- Max weight/sash: 160 kg
- Multipoint locking hardware
- Maximum glazing thickness: 22mm



40 series

Non-thermal break aluminum fold up window

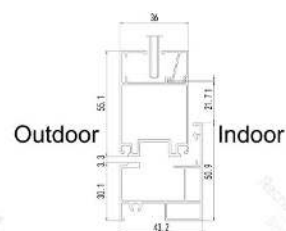

GENERAL SPECIFICATIONS

- profile thickness: 1.4mm
- Single glazed glass
- color powder coating

OPTIONS

- Multiple glazing packages and finish options
- Mosquito screens available
- Dual-sealed warm edge spacer
- argon gas infill

40 series

Non-thermal break aluminum fold up window

PERFORMANCE

DESCRIPTION	VALUE	DESCRIPTION	VALUE
SHGC	0.14-0.97	U-Value (BTU/h·ft ² ·°F)	0.24-0.6
Air Infiltration (cfm/ft ²)	0.01	STC (dB)	30
Water resistance (psf)	12.11	VT	0.13-0.85

*Values may vary depending on glazing packages utilized

STANDARD FEATURES

- Opening: fold up of 2 sashes
- Sections:
 - Frame: 43mm
 - Sash: 36mm
- Maximum dimensions/sash:
 - Width up to 1,200mm
 - Height up to 2,400mm
- Max weight/sash: 160 kg
- Multipoint locking hardware
- Maximum glazing thickness: 22mm



55 series

Non-thermal break aluminum fold up window



GENERAL SPECIFICATIONS

- profile thickness: 1.4mm
- double glazed glass
- color powder coating

OPTIONS

- Multiple glazing packages and finish options
- Mosquito screens available
- Dual-sealed warm edge spacer
- argon gas infill



55 series

Non-thermal break aluminum fold up window

PERFORMANCE

DESCRIPTION	VALUE	DESCRIPTION	VALUE
SHGC	0.14-0.97	U-Value (BTU/h-ft ² ·°F)	0.24-0.6
Air Infiltration (cfm/ft ²)	0.01	STC (dB)	38
Water resistance (psf)	12.11	VT	0.13-0.85

*Values may vary depending on glazing packages utilized

STANDARD FEATURES

- Opening: fold up of 2 sashes
- Sections:
 - Frame: 43mm
 - Sash: 36mm
- Maximum dimensions/sash:
 - Width up to 1,200mm
 - Height up to 2,400mm
- Max weight/sash: 160 kg
- Multipoint locking hardware
- Maximum glazing thickness: 22mm



60 series

Non-thermal break aluminum fold up window

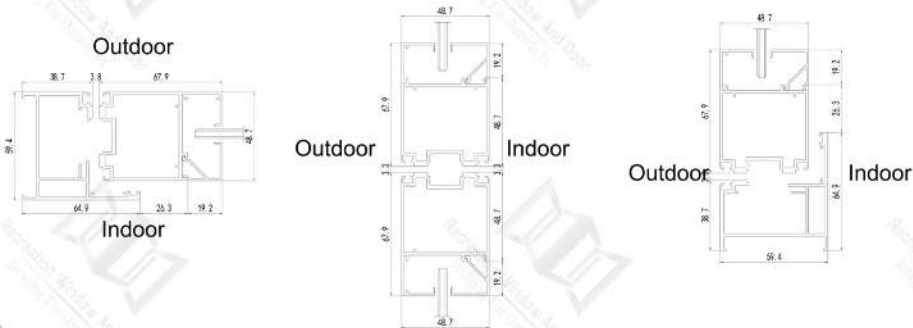

GENERAL SPECIFICATIONS

- Profile thickness: 1.6mm
- Double glazed glass
- Color powder coating

STANDARD FEATURES

- Opening: fold up of 2 sashes
- Sections:
 - Frame: 60mm - Sash: 49mm
- Maximum dimensions/sash:
 - Width up to 1,200mm
 - Height up to 2,400mm
- Max weight/sash: 160 kg
- Multipoint locking hardware
- Maximum glazing thickness: 22mm



60 series

Non-thermal break aluminum fold up window



PERFORMANCE

DESCRIPTION	VALUE	DESCRIPTION	VALUE
SHGC	0.14-0.97	U-Value (BTU/h·ft²·°F)	0.24-0.6
Air Infiltration (cfm/ft²)	0.01	STC (dB)	35
Water resistance (psf)	12.11	VT	0.13-0.85

*Values may vary depending on glazing packages utilized

OPTIONS

- Multiple glazing packages and finish options
- Mosquito screens available
- Dual-sealed warm edge spacer
- argon gas infill

100 series

Non-thermal break fold up window

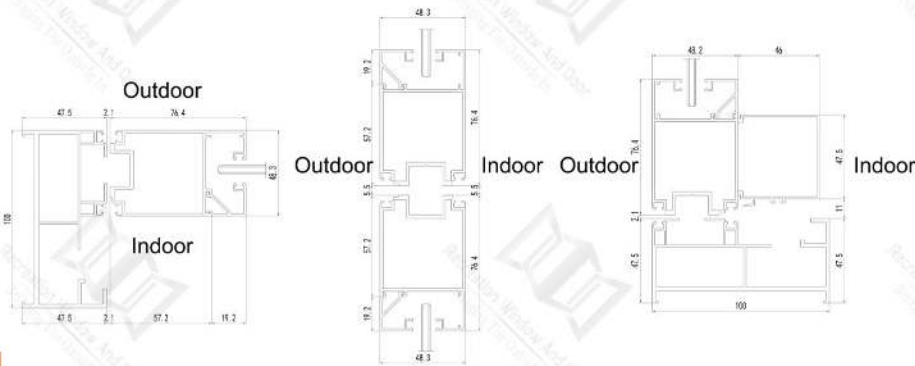

GENERAL SPECIFICATIONS

- profile thickness: 1.4mm
- double glazed glass
- color powder coating

OPTIONS

- Multiple glazing packages and finish options
- Mosquito screens available
- Dual-sealed warm edge spacer
- argon gas infill



100 series

Non-thermal break fold up window

PERFORMANCE

DESCRIPTION	VALUE	DESCRIPTION	VALUE
SHGC	0.14-0.97	U-Value (BTU/h·ft ² ·°F)	0.24-0.6
Air Infiltration (cfm/ft ²)	0.01	STC (dB)	38
Water resistance (psf)	12.11	VT	0.13-0.85

*Values may vary depending on glazing packages utilized

STANDARD FEATURES

- Opening: fold up of 2 sashes
- Sections:
 - Frame: 43mm
 - Sash: 36mm
- Maximum dimensions/sash:
 - Width up to 1,200mm
 - Height up to 2,400mm
- Max weight/sash: 160 kg
- Multipoint locking hardware
- Maximum glazing thickness: 22mm



FOLDING

WINDOWS & DOORS



Folding Sliding Doors are the most advanced solution to merge or divide interior and exterior spaces. Our latest generation of folding sliding doors combines the flexibility to open large openings while provide extraordinary strength and security. All our folding sliding door systems are made to size and get customized to be the perfect fit for your application.

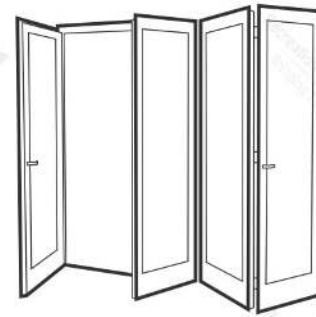

58 series

Non-thermal break aluminum folding window & door

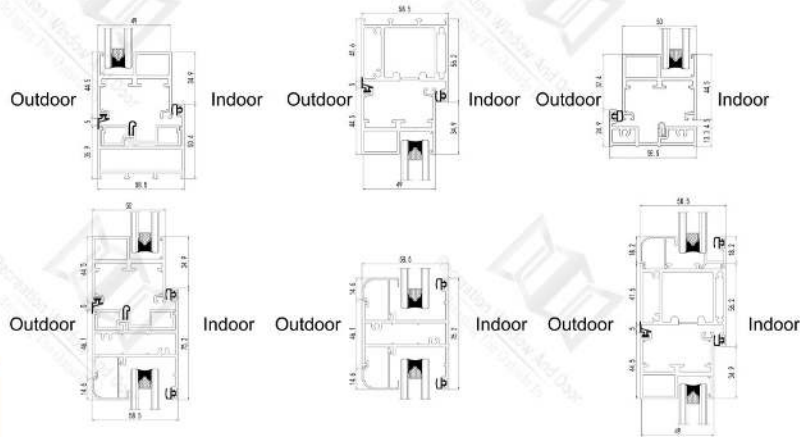

STANDARD FEATURES

- Operation:
 - Inward Opening: Bi-fold from multiple sashes
 - Outward Opening: Bi-fold from multiple sashes
 - Possibility of a 90° corner sash without mullion
- Sections:
 - Frame: 58mm - Sash: 50mm
- Maximum dimensions/sash:
 - Width up to 1,000mm - Height up to 2,500mm
- Max weight/sash: 100 kg (depending on the quantity of hinges)
- Multipoint locking hardware
- Maximum glazing thickness: 22mm



58 series

Non-thermal break aluminum folding window & door

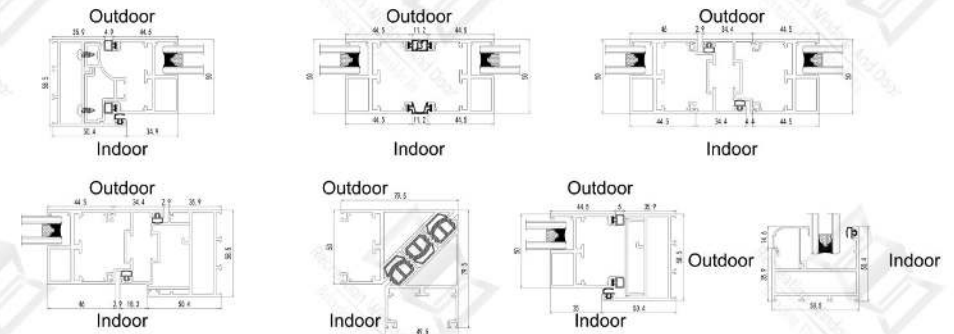

PERFORMANCE

DESCRIPTION	VALUE	DESCRIPTION	VALUE
SHGC	0.14-0.97	U-Value (BTU/h-ft ² ·°F)	0.24-0.6
Air Infiltration (cfm/ft ²)	0.01	STC (dB)	35
Water resistance (psf)	12.11	VT	0.13-0.85

*Values may vary depending on glazing packages utilized

GENERAL SPECIFICATIONS

- profile thickness: 2.0mm
- double glazed glass
- with concealed hinges
- color powder coating

OPTIONS

- Multiple glazing packages and finish options
- Mosquito screens available
- Dual-sealed warm edge spacer
- argon gas infill

78 series

Non-thermal break aluminum folding door

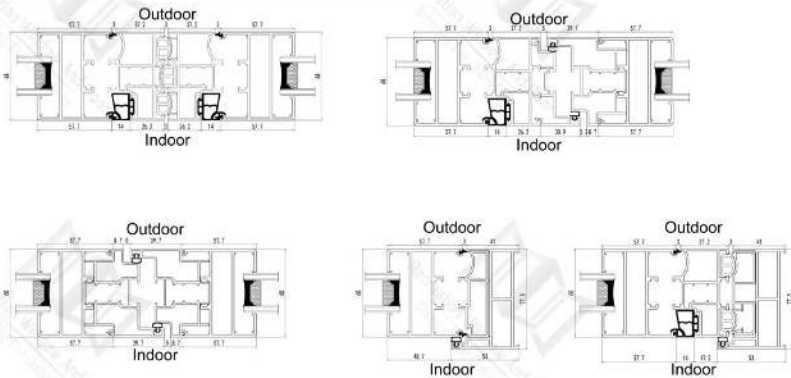

STANDARD FEATURES

- Operation:
 - Inward Opening: Bi-fold from multiple sashes
 - Outward Opening: Bi-fold from multiple sashes
 - Possibility of a 90° corner sash without mullion
- Sections:
 - Frame: 78mm - Sash: 68mm
 - Maximum dimensions/sash:
 - Width up to 1,100mm - Height up to 3,500mm
 - Max weight/sash: 150 kg (depending on the quantity of hinges)
 - Multipoint locking hardware
 - Maximum glazing thickness: 38mm

78 series

Non-thermal break aluminum folding door

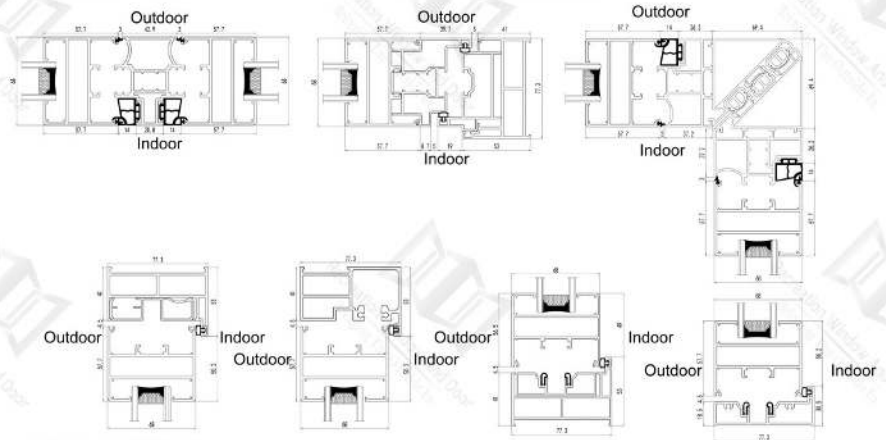

PERFORMANCE

DESCRIPTION	VALUE	DESCRIPTION	VALUE
SHGC	0.14-0.97	U-Value (BTU/h·ft ² ·°F)	0.24-0.6
Air Infiltration (cfm/ft ²)	0.01	STC (dB)	38
Water resistance (psf)	12.11	VT	0.13-0.85

*Values may vary depending on glazing packages utilized

GENERAL SPECIFICATIONS

- profile thickness: 2.0mm
- double glazed glass
- with concealed hinges
- color powder coating

OPTIONS

- Multiple glazing packages and finish options
- Mosquito screens available
- Dual-sealed warm edge spacer
- argon gas infill

78 series

Thermal break aluminum folding door

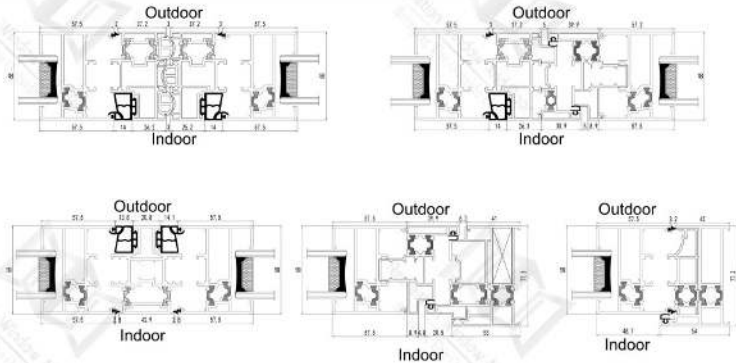

78 series

Thermal break aluminum folding door

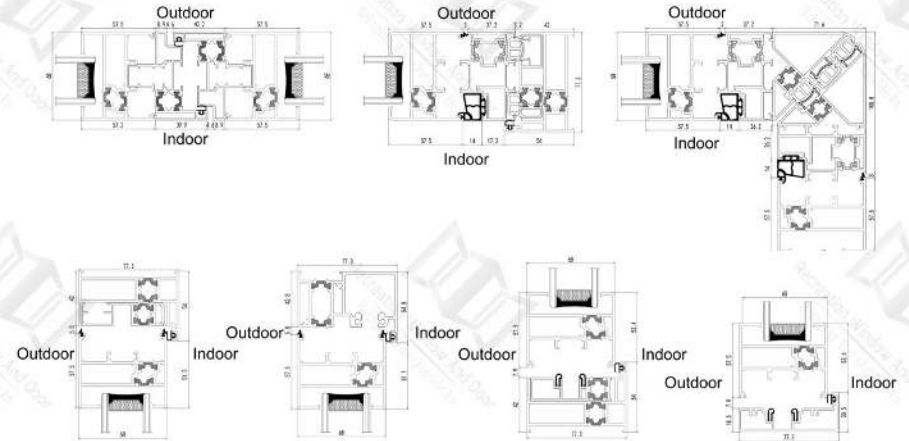

37

STANDARD FEATURES

- Operation:
 - Inward Opening: Bi-fold from multiple sashes
 - Outward Opening: Bi-fold from multiple sashes
 - Possibility of a 90° corner sash without mullion
- Sections:
 - Frame: 78mm - Sash: 68mm
 - Maximum dimensions/sash:
 - Width up to 1,100mm - Height up to 3,500mm
 - Max weight/sash: 150 kg(depending on the quantity of hinges)
 - Multipoint locking hardware
 - Maximum glazing thickness: 38mm



38

PERFORMANCE

DESCRIPTION	VALUE	DESCRIPTION	VALUE
SHGC	0.14-0.97	U-Value (BTU/h-ft ² ·°F)	0.24-0.6
Air Infiltration (cfm/ft ²)	0.01	STC (dB)	41
Water resistance (psf)	12.11	VT	0.13-0.85

*Values may vary depending on glazing packages utilized

GENERAL SPECIFICATIONS

- profile thickness: 2.0mm
- double glazed glass
- with concealed hinges
- color powder coating

OPTIONS

- Multiple glazing packages and finish options
- Mosquito screens available
- Dual-sealed warm edge spacer
- argon gas infill

98 series

Non-thermal break aluminum folding door

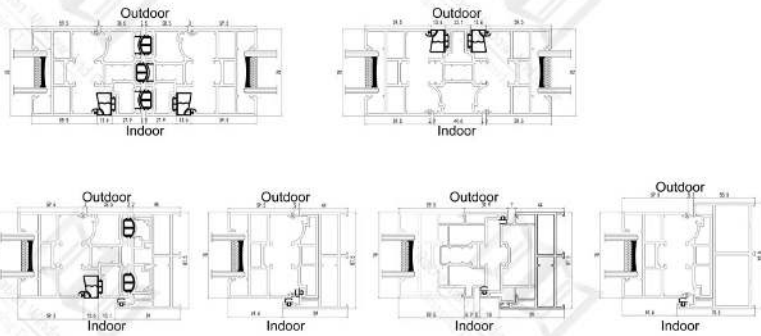

39

STANDARD FEATURES

- Operation:
 - Inward Opening: Bi-fold from multiple sashes
 - Outward Opening: Bi-fold from multiple sashes
 - Possibility of a 90° corner sash without mullion
- Sections:
 - Frame: 97mm - Sash: 78mm
 - Maximum dimensions/sash:
 - Width up to 1,200mm - Height up to 4,200mm
 - Max weight/sash: 180 kg (depending on the quantity of hinges)
 - Multipoint locking hardware
 - Maximum glazing thickness: 40mm



98 series

Non-thermal break aluminum folding door

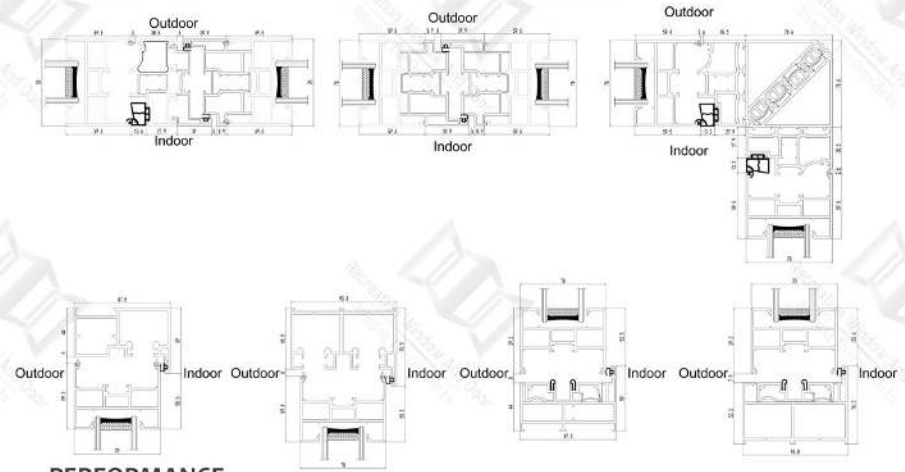

40

PERFORMANCE

DESCRIPTION	VALUE	DESCRIPTION	VALUE
SHGC	0.14-0.97	U-Value (BTU/h-ft ² -°F)	0.24-0.6
Air Infiltration (cfm/ft ²)	0.01	STC (dB)	38
Water resistance (psf)	12.11	VT	0.13-0.85

*Values may vary depending on glazing packages utilized

GENERAL SPECIFICATIONS

- profile thickness: 2.0mm
- double glazed glass
- with concealed hinges
- color powder coating

OPTIONS

- Multiple glazing packages and finish options
- Mosquito screens available
- Dual-sealed warm edge spacer
- argon gas infill

98 series

Thermal break aluminum folding door

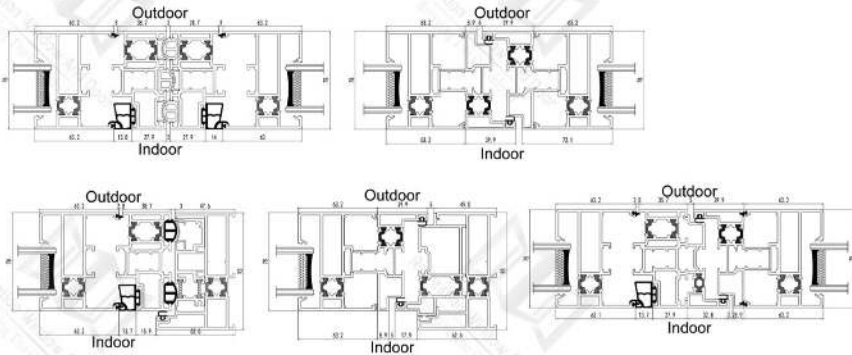

98 series

Thermal break aluminum folding door

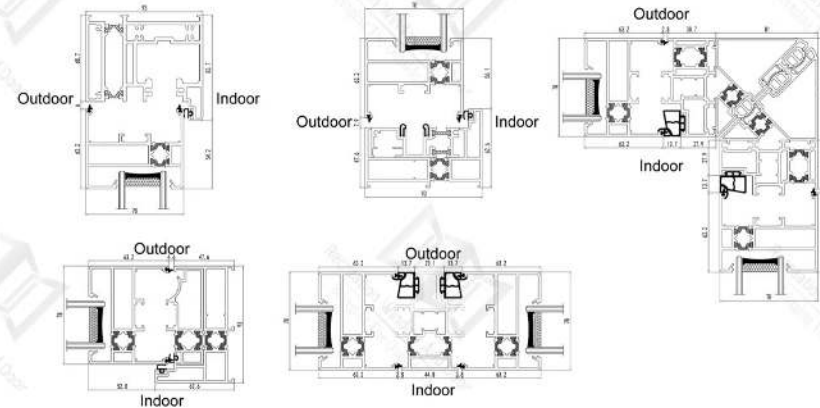

41

STANDARD FEATURES

- Operation:
 - Inward Opening: Bi-fold from multiple sashes
 - Outward Opening: Bi-fold from multiple sashes
 - Possibility of a 90° corner sash without mullion
- Sections:
 - Frame: 97mm - Sash: 78mm
- Maximum dimensions/sash:
 - Width up to 1,200mm - Height up to 4,200mm
- Max weight/sash: 180 kg (depending on the quantity of hinges)
- Multipoint locking hardware
- Maximum glazing thickness: 40mm



42

PERFORMANCE

DESCRIPTION	VALUE	DESCRIPTION	VALUE
SHGC	0.14-0.97	U-Value (BTU/h-ft ² ·°F)	0.24-0.6
Air Infiltration (cfm/ft ²)	0.01	STC (dB)	41
Water resistance (psf)	12.11	VT	0.13-0.85

*Values may vary depending on glazing packages utilized

GENERAL SPECIFICATIONS

- profile thickness: 2.0mm
- double glazed glass
- with concealed hinges
- color powder coating

OPTIONS

- Multiple glazing packages and finish options
- Mosquito screens available
- Dual-sealed warm edge spacer
- argon gas infill

150 series

Non-thermal break aluminum folding door

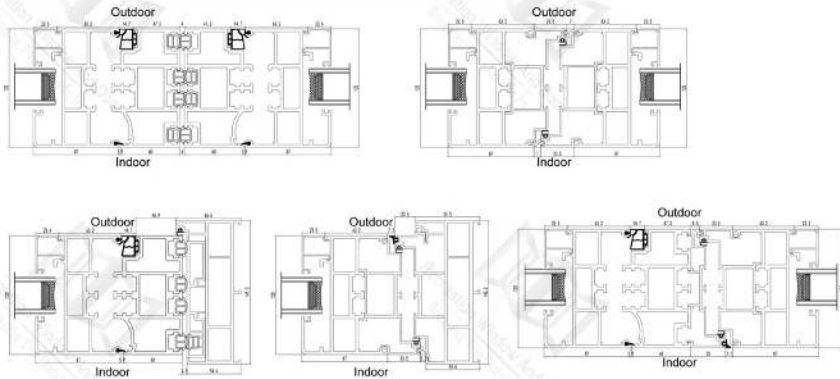

150 series

Non-thermal break aluminum folding door

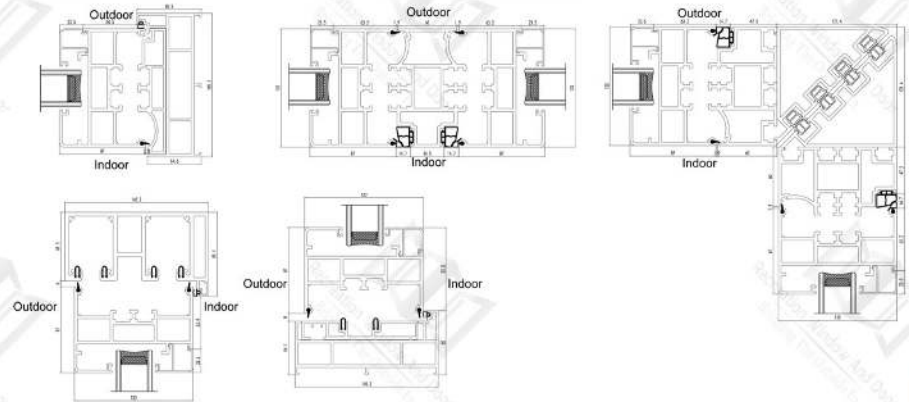

43

STANDARD FEATURES

- Operation:
 - Inward Opening: Bi-fold from multiple sashes
 - Outward Opening: Bi-fold from multiple sashes
 - Possibility of a 90° corner sash without mullion
- Sections:
 - Frame: 145mm - Sash: 120mm
 - Maximum dimensions/sash:
 - Width up to 1,600mm - Height up to 6,000mm
 - Max weight/sash: 350 kg(depending on the quantity of hinges)
 - Multipoint locking hardware
 - Maximum glazing thickness: 42mm



44

PERFORMANCE

DESCRIPTION	VALUE	DESCRIPTION	VALUE
SHGC	0.14-0.97	U-Value (BTU/h·ft²·°F)	0.24-0.6
Air Infiltration (cfm/ft²)	0.01	STC (dB)	38
Water resistance (psf)	12.11	VT	0.13-0.85

*Values may vary depending on glazing packages utilized

GENERAL SPECIFICATIONS

- profile thickness: 3.0-4.0mm
- double glazed glass
- with concealed hinges
- color powder coating

OPTIONS

- Multiple glazing packages and finish options
- Mosquito screens available
- Dual-sealed warm edge spacer
- argon gas infill

70 series

Thermal break aluminum panoramic folding sliding door



STANDARD FEATURES

- Operation:
 - Inward Opening: Bi-fold from multiple sashes
 - Outward Opening: Bi-fold from multiple sashes
 - Possibility of a 90° corner sash without mullion
- Sections:
 - Frame: 70mm - Sash: 60mm
 - Maximum dimensions/sash:
 - Width up to 1,050mm - Height up to 2,500mm
 - Max weight/sash: 100 kg
 - Multipoint locking hardware
 - Maximum glazing thickness: 31mm

70 series

Thermal break aluminum panoramic folding sliding door



PERFORMANCE

DESCRIPTION	VALUE	DESCRIPTION	VALUE
SHGC	0.14-0.97	U-Value (BTU/h·ft²·°F)	0.24-0.6
Air Infiltration (cfm/ft²)	0.01	STC (dB)	41
Water resistance (psf)	12.11	VT	0.13-0.85

*Values may vary depending on glazing packages utilized

GENERAL SPECIFICATIONS

- profile thickness: 2.0mm
- double glazed glass
- with concealed hinges
- color powder coating

OPTIONS

- Multiple glazing packages and finish options
- Mosquito screens available
- Dual-sealed warm edge spacer
- argon gas infill

SLIDING

PATIO DOORS



Sliding glass doors and large windows often serve as vital design components when space efficiency is of high importance. Offering large unobstructed glass areas that maximize the amount of light entering the interior, with minimal impact on the usage of space. PUERTANA's sliding systems are suitable for large dimensions with glass surface coverage of up to 94%. The Sliding System features for a comfortable use inside homes and commercial spaces.



110/170 series

Non-thermal break aluminum sliding door

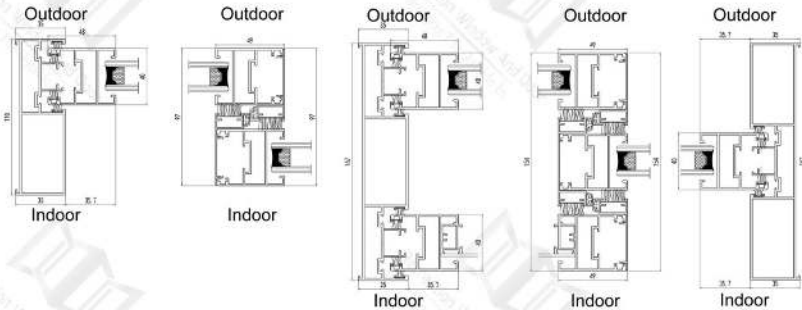

STANDARD FEATURES

- Sliding of 2, 3, 4 & 6 Sashes
- Sections:
 - Frame: 120mm / 167mm
 - Sash: 40mm
- Maximum dimensions/sash:
 - Width up to 1,500mm
 - Height up to 2,300mm
- Max weight/sash: 100 kg
- Multipoint locking hardware
- Maximum glazing thickness: 24mm



110/170 series

Non-thermal break aluminum sliding door

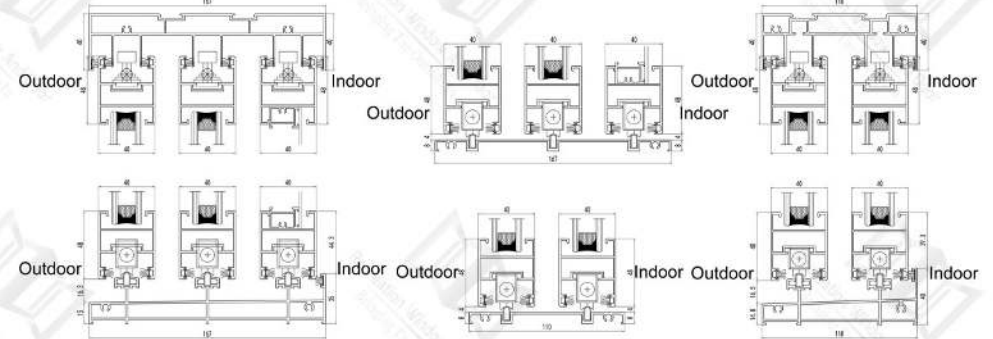

PERFORMANCE

DESCRIPTION	VALUE	DESCRIPTION	VALUE
SHGC	0.14-0.97	U-Value (BTU/h·ft ² ·°F)	0.24-0.6
Air Infiltration (cfm/ft ²)	0.01	STC (dB)	30
Water resistance (psf)	12.11	VT	0.13-0.85

*Values may vary depending on glazing packages utilized

OPTIONS

- Multiple glazing packages and finish options
- Dual-sealed warm edge spacer
- argon gas infill

GENERAL SPECIFICATIONS

- Profile thickness: 1.4mm
- Double glazed glass
- Color powder coating
- Stainless steel wire mesh
- Possibility of 3 Rails

130/200 series

Non-thermal break aluminum sliding door

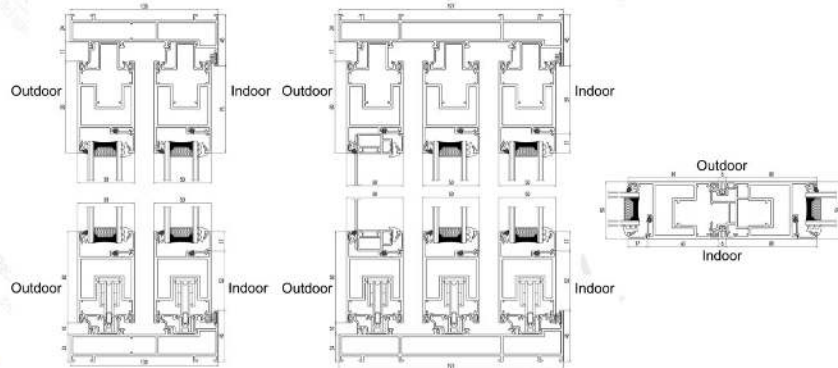

130/200 series

Non-thermal break aluminum sliding door

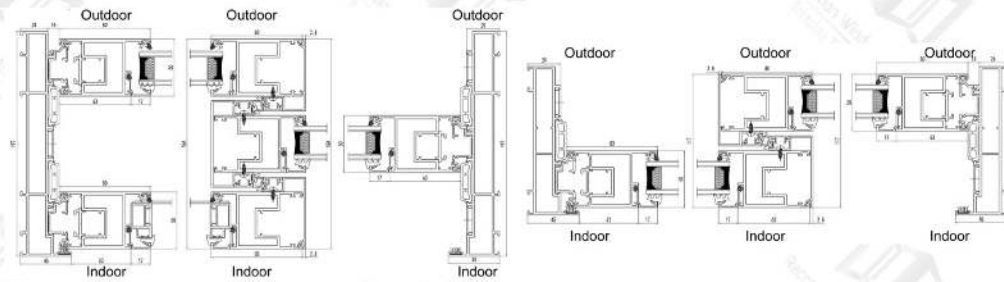

PERFORMANCE

DESCRIPTION	VALUE	DESCRIPTION	VALUE
SHGC	0.14-0.97	U-Value (BTU/h·ft ² ·°F)	0.24-0.6
Air Infiltration (cfm/ft ²)	0.01	STC (dB)	38
Water resistance (psf)	12.11	VT	0.13-0.85

*Values may vary depending on glazing packages utilized

GENERAL SPECIFICATIONS

- Profile thickness: 2.0mm
- Double glazed glass
- Color powder coating
- Stainless steel wire mesh
- Possibility of 3 Rails

OPTIONS

- Multiple glazing packages and finish options
- Dual-sealed warm edge spacer
- argon gas infill
- lift and slide system

STANDARD FEATURES

- Sliding of 2, 3, 4 & 6 Sashes
- Sections:
 - Frame: 130mm / 200mm
 - Sash: 50mm
- Maximum dimensions/sash:
 - Width up to 1,500mm
 - Height up to 3,500mm
- Max weight/sash: 250 kg
- Multipoint locking hardware
- Maximum glazing thickness: 38mm



130/200 series

Thermal break aluminum sliding door

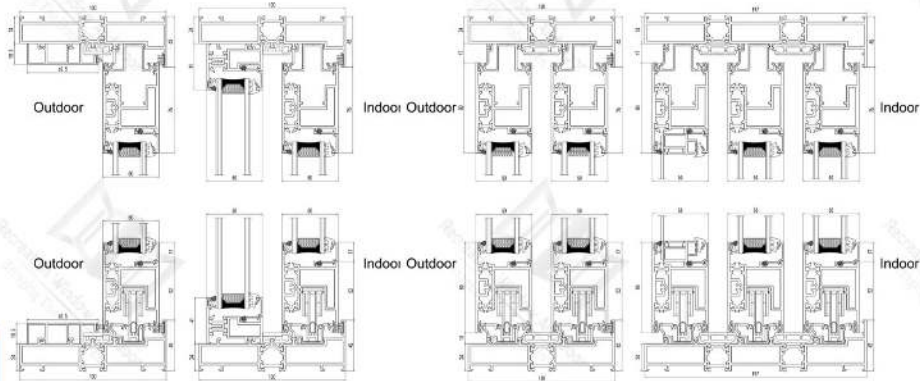

51

STANDARD FEATURES

- Sliding of 2, 3, 4, 6 & even number Sashes
- Sections:
 - Frame: 130mm / 200mm
 - Sash: 50mm
- Maximum dimensions/sash:
 - Width up to 1,500mm
 - Height up to 3,500mm
- Max weight/sash: 250 kg
- Multipoint locking hardware
- Maximum glazing thickness: 38mm



130/200 series

Thermal break aluminum sliding door

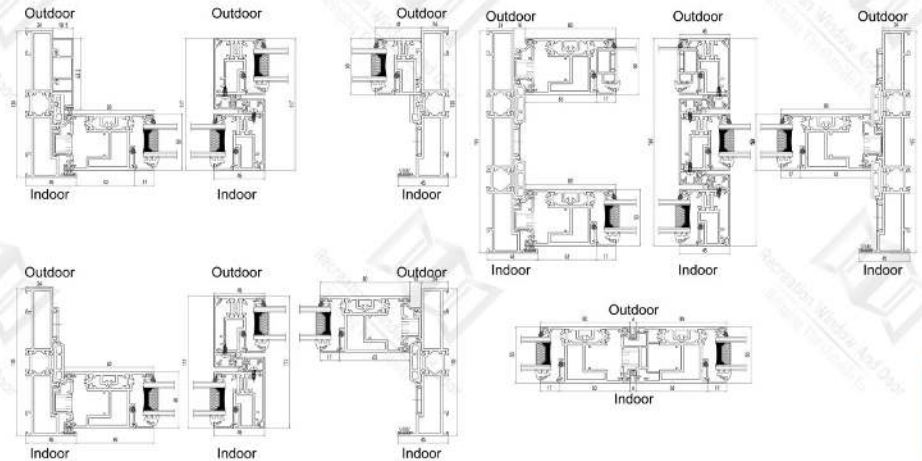

52

PERFORMANCE

DESCRIPTION	VALUE	DESCRIPTION	VALUE
SHGC	0.14-0.97	U-Value (BTU/h·ft ² ·°F)	0.24-0.6
Air Infiltration (cfm/ft ²)	0.01	STC (dB)	41
Water resistance (psf)	12.11	VT	0.13-0.85

*Values may vary depending on glazing packages utilized

GENERAL SPECIFICATIONS

- Profile thickness: 2.0mm
- Double glazed glass
- Possibility of dual color
- Color powder coating
- Stainless steel wire mesh
- Possibility of multiple Rails

OPTIONS

- Multiple glazing packages and finish options
- Dual-sealed warm edge spacer
- argon gas infill
- lift and slide system

143/220 series

Thermal break slimline aluminum sliding door

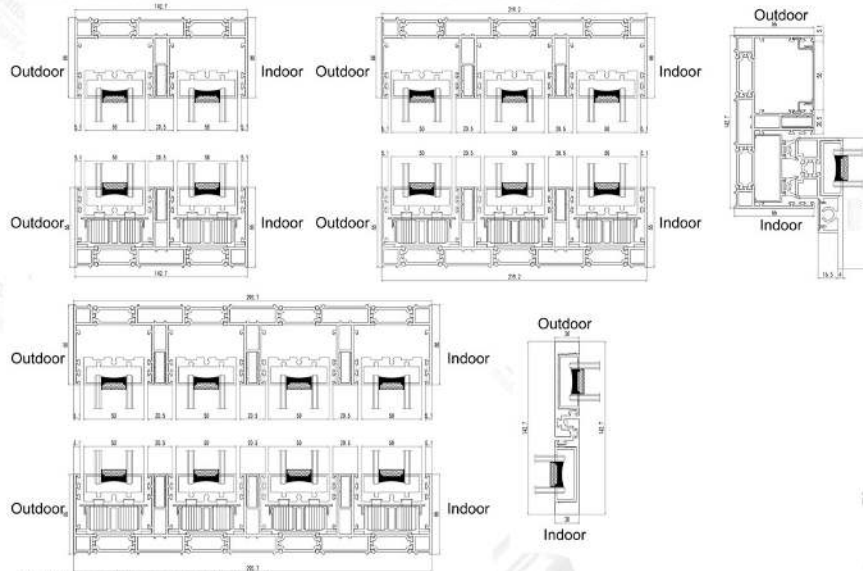

STANDARD FEATURES

- Sliding of 2, 3, 4, 6 & even number Sashes
- Sections:
 - Frame: 143mm / 220mm - Sash: 50mm
- Maximum dimensions/sash:
 - Width up to 3000mm
 - Height up to 3,500mm
- Max weight/sash: 300 kg
- Multipoint locking hardware
- Maximum glazing thickness: 31mm



143/220 series

Thermal break slimline aluminum sliding door

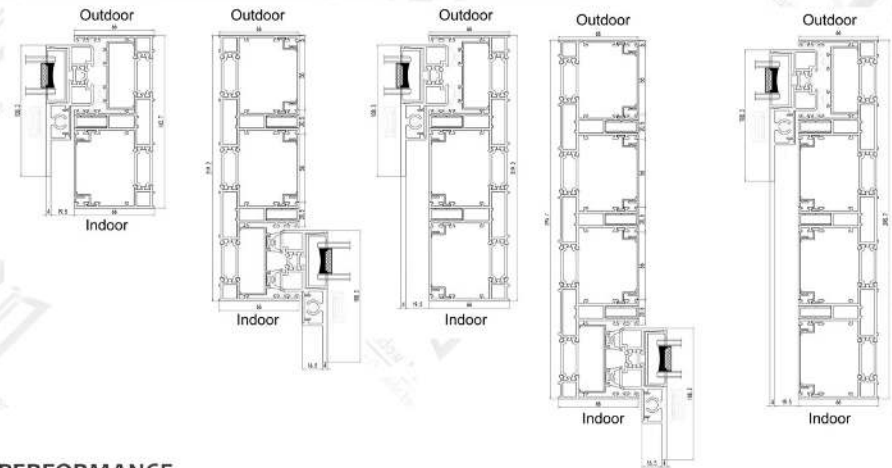

PERFORMANCE

DESCRIPTION	VALUE	DESCRIPTION	VALUE
SHGC	0.14-0.97	U-Value (BTU/h·ft ² ·°F)	0.24-0.6
Air Infiltration (cfm/ft ²)	0.01	STC (dB)	41
Water resistance (psf)	12.11	VT	0.13-0.85

*Values may vary depending on glazing packages utilized

GENERAL SPECIFICATIONS

- Profile thickness: 2.0mm
- Double glazed glass
- Possibility of dual color
- Color powder coating
- Stainless steel wire mesh
- Possibility of multiple Rails

OPTIONS

- Multiple glazing packages and finish options
- Dual-sealed warm edge spacer
- argon gas infill

SINGLE & FRENCH PATIO DOORS



Add a traditional touch to your patio area with a set of French or single doors.

Not all properties require wide expanses of opening doors. Some just need a simple yet effective door, giving easy access to the garden or outside. Manufactured to open either inwards or outwards, whichever option is better suited to your space, they are also hinged to open a full 180 degrees, truly bringing the outside in.



65 series

Thermal break aluminum casement door

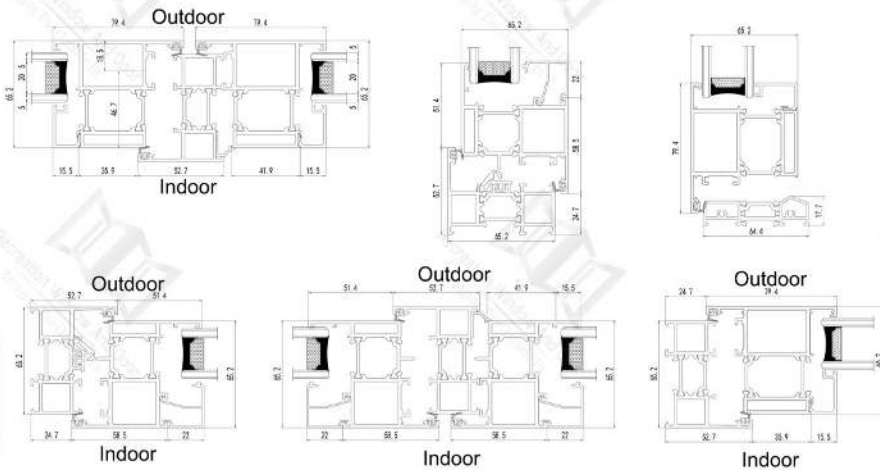

GENERAL SPECIFICATIONS

- Profile thickness: 2.0mm
- Double glazed glass
- Radius tops and arches available
- Possibility of dual color
- Color powder coating



65 series

Thermal break aluminum casement door

PERFORMANCE

DESCRIPTION	VALUE	DESCRIPTION	VALUE
SHGC	0.14-0.97	U-Value (BTU/h-ft ² ·°F)	0.24-0.6
Air Infiltration (cfm/ft ²)	0.01	STC (dB)	41
Water resistance (psf)	12.11	VT	0.13-0.85

*Values may vary depending on glazing packages utilized

OPTIONS

- Possibility of incorporating hardware with concealed hinges
- Multiple glazing packages and finish options
- Mosquito screens available
- Dual-sealed warm edge spacer
- argon gas infill

STANDARD FEATURES

- Opening: tilt and turn, side hung and top hung of 1 or 2 sashes
- Sections:
 - Frame: 65mm
 - Sash: 65mm
- Maximum dimensions/sash:
 - Width up to 1,500mm
 - Height up to 3,500mm
- Max weight/sash: 300 kg
- Multipoint locking hardware
- Maximum glazing thickness: 32mm



75 series

Thermal break aluminum casement door

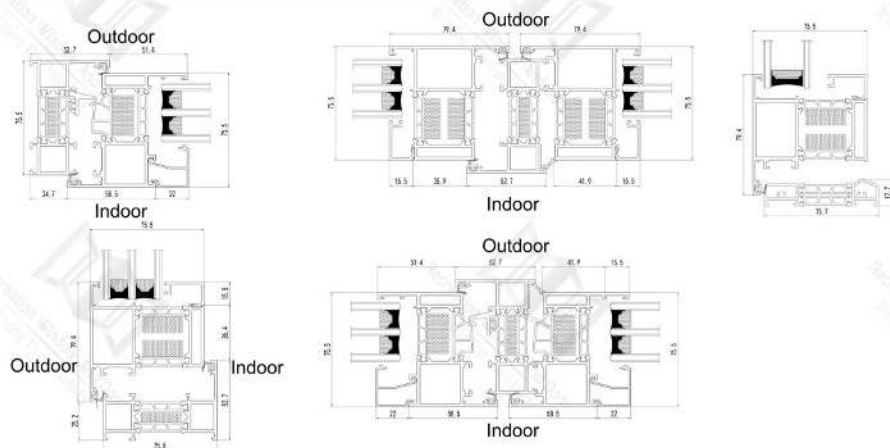

GENERAL SPECIFICATIONS

- Profile thickness: 2.0mm
- Triple glazed glass
- Radius tops and arches available
- Possibility of dual color
- Color powder coating



75 series

Thermal break aluminum casement door

PERFORMANCE

DESCRIPTION	VALUE	DESCRIPTION	VALUE
SHGC	0.14-0.97	U-Value (BTU/h-ft ² ·°F)	0.24-0.6
Air Infiltration (cfm/ft ²)	0.01	STC (dB)	45
Water resistance (psf)	12.11	VT	0.13-0.85

*Values may vary depending on glazing packages utilized

OPTIONS

- Possibility of incorporating hardware with concealed hinges
- Multiple glazing packages and finish options
- Mosquito screens available
- Dual-sealed warm edge spacer
- argon gas infill

STANDARD FEATURES

- Opening: tilt and turn, side hung and top hung of 1 or 2 sashes
- Sections:
 - Frame: 75mm
 - Sash: 75mm
- Maximum dimensions/sash:
 - Width up to 1,500mm
 - Height up to 3,500mm
- Max weight/sash: 300 kg
- Multipoint locking hardware
- Maximum glazing thickness: 41mm



85 series

Thermal break aluminum wood casement window

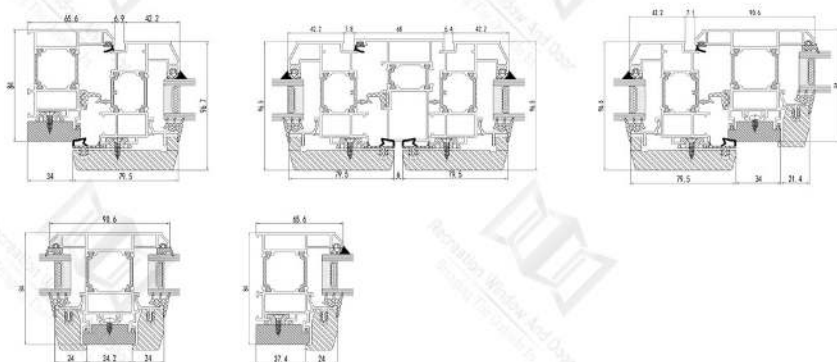

59

STANDARD FEATURES

- Opening: tilt and turn, side hung of 1 or 2 sashes
- Sections:
 - Frame: 85mm
 - Sash: 97mm
- Maximum dimensions/sash:
 - Width up to 1,500mm
 - Height up to 3,500mm
- Max weight/sash: 300 kg
- Multipoint locking hardware
- Maximum glazing thickness: 41mm



85 series

Thermal break aluminum wood casement window



60

PERFORMANCE

DESCRIPTION	VALUE	DESCRIPTION	VALUE
SHGC	0.14-0.97	U-Value (BTU/h·ft ² ·°F)	0.24-0.6
Air Infiltration (cfm/ft ²)	0.01	STC (dB)	45
Water resistance (psf)	12.11	VT	0.13-0.85

*Values may vary depending on glazing packages utilized

GENERAL SPECIFICATIONS

- Profile thickness: 1.6mm
- Double glazed glass
- Radius tops and arches available
- Possibility of dual color
- Color powder coating

OPTIONS

- Multiple glazing packages and finish options
- Mosquito screens available
- Dual-sealed warm edge spacer
- Argon gas infill
- Optional solid wood material

85 series

Thermal break aluminum wood casement window

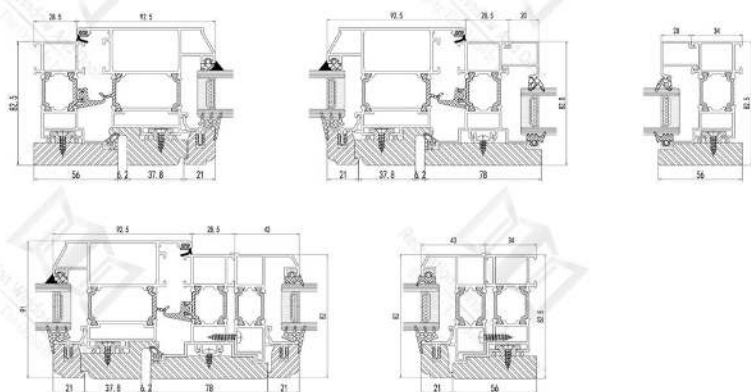

61

STANDARD FEATURES

- Opening: side hung, top hung of 1 or 2 sashes
- Sections:
 - Frame: 85mm
 - Sash: 97mm
- Maximum dimensions/sash:
 - Width up to 1,500mm
 - Height up to 3,500mm
- Max weight/sash: 300 kg
- Multipoint locking hardware
- Maximum glazing thickness: 41mm



85 series

Thermal break aluminum wood casement window



62

PERFORMANCE

DESCRIPTION	VALUE	DESCRIPTION	VALUE
SHGC	0.14-0.97	U-Value (BTU/h·ft²·°F)	0.24-0.6
Air Infiltration (cfm/ft²)	0.01	STC (dB)	45
Water resistance (psf)	12.11	VT	0.13-0.85

*Values may vary depending on glazing packages utilized

GENERAL SPECIFICATIONS

- Profile thickness: 1.6mm
- Double glazed glass
- Radius tops and arches available
- Possibility of dual color
- Color powder coating

OPTIONS

- Multiple glazing packages and finish options
- Mosquito screens available
- Dual-sealed warm edge spacer
- Argon gas infill
- Optional solid wood material

87 series

Aluminum wood casement window & door

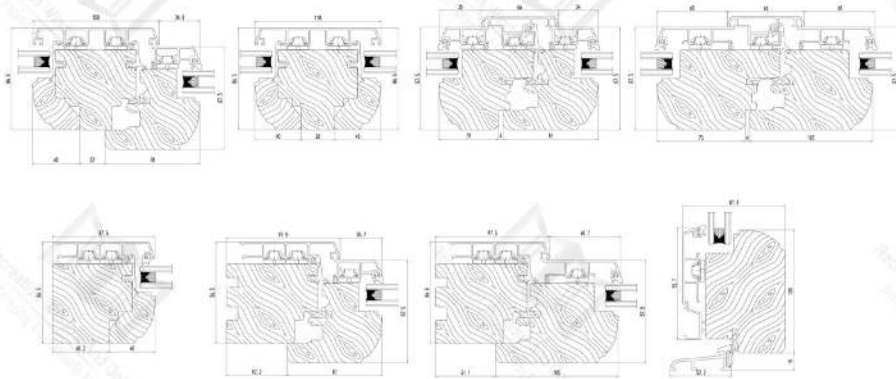

STANDARD FEATURES

- Opening: tilt and turn, side hung of 1 or 2 sashes
- Sections:
 - Frame: 86mm
 - Sash: 88mm
- Maximum dimensions/sash:
 - Width up to 1,500mm
 - Height up to 3,500mm
- Max weight/sash: 300 kg
- Multipoint locking hardware
- Maximum glazing thickness: 26mm



87 series

Aluminum wood casement window & door



PERFORMANCE

DESCRIPTION	VALUE	DESCRIPTION	VALUE
SHGC	0.14-0.97	U-Value (BTU/h·ft ² ·°F)	0.24-0.6
Air Infiltration (cfm/ft ²)	0.01	STC (dB)	48
Water resistance (psf)	12.11	VT	0.13-0.85

*Values may vary depending on glazing packages utilized

GENERAL SPECIFICATIONS

- Double glazed glass
- Radius tops and arches available
- Optional color painted

OPTIONS

- Multiple glazing packages and finish options
- Mosquito screens available
- Dual-sealed warm edge spacer
- Argon gas infill
- Optional solid wood material

Aluminum wood sliding door



There is a safe solution for the simple operation of large and heavy lift-slide systems: The innovative SOFT CLOSE function, which can be invisibly integrated into the sash. This brakes the sash gently just before the end position and then pulls it shut automatically. This minimises any risk of injury in the case of improper operation and precludes any material damage.

Clever convenient solutions: From the enregy store to the positive control.

There is always a magic word for maximum ease of use. When it comes to lift-slide systems, this is "energy storage". A specialspring hidden in the comfort gear uses the weight of the sash to lift it even more easily. The "positive control" is decisive for larger parallel slide & tilt doors: Merely turning the handle moves the sash conveniently into the desired position.

Aluminum wood sliding door



Innovative boogie wheels: Putting heavyweights into motion really easily.

Sophisticated product details and the highest quality materials allow sliding doors of all sizes to slide back and forth almost weightlessly. This is achieved by very special bogie wheels which distribute the load of the sash across eight rollers.

158 /228 series

Thermal break aluminum wood sliding door

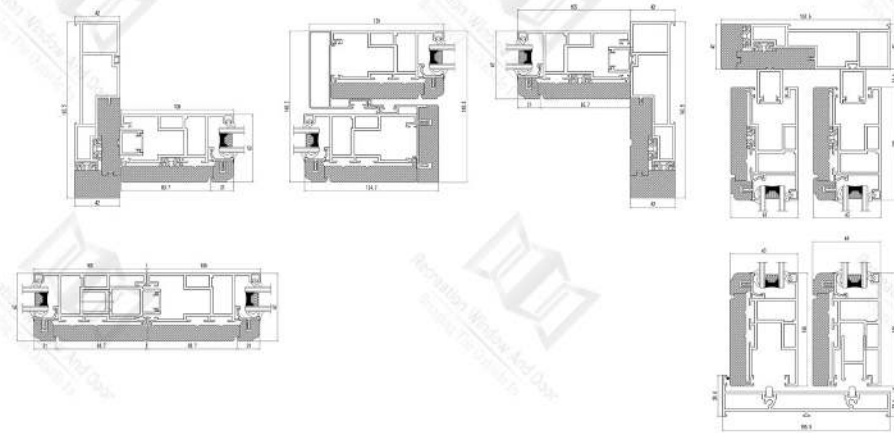

158 /228 series

Thermal break aluminum wood sliding door

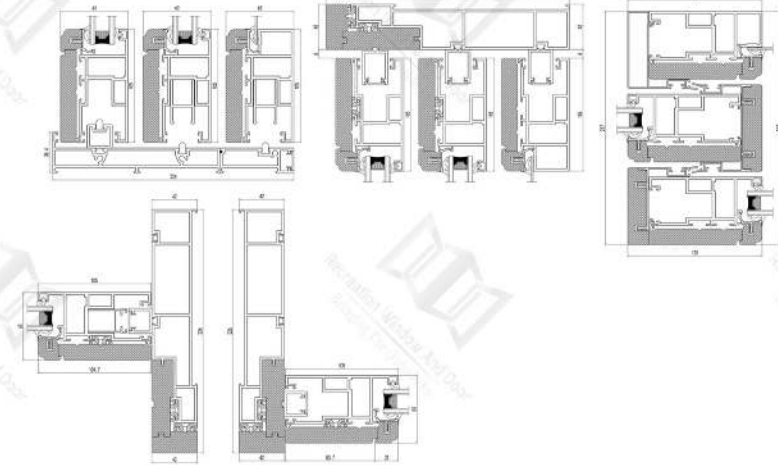

65

STANDARD FEATURES

- Sliding of 2, 3, 4 & 6 Sashes
- Sections:
 - Frame: 163mm / 226mm
 - Sash: 63mm
- Maximum dimensions/sash:
 - Width up to 3,000mm
 - Height up to 3,500mm
- Max weight/sash: 300 kg
- Multipoint locking hardware
- Maximum glazing thickness: 30mm



PERFORMANCE

DESCRIPTION	VALUE	DESCRIPTION	VALUE
SHGC	0.14-0.97	U-Value (BTU/h-ft ² -°F)	0.24-0.6
Air Infiltration (cfm/ft ²)	0.01	STC (dB)	41
Water resistance (psf)	12.11	VT	0.13-0.85

*Values may vary depending on glazing packages utilized

OPTIONS

- Multiple glazing packages and finish options
- Dual-sealed warm edge spacer
- Argon gas infill
- Optional solid wood material

GENERAL SPECIFICATIONS

- Profile thickness: 2.3mm
- Double glazed glass
- Color powder coating
- Stainless steel wire mesh
- Possibility of 3 Rails

66

88 series

Aluminum wood folding door

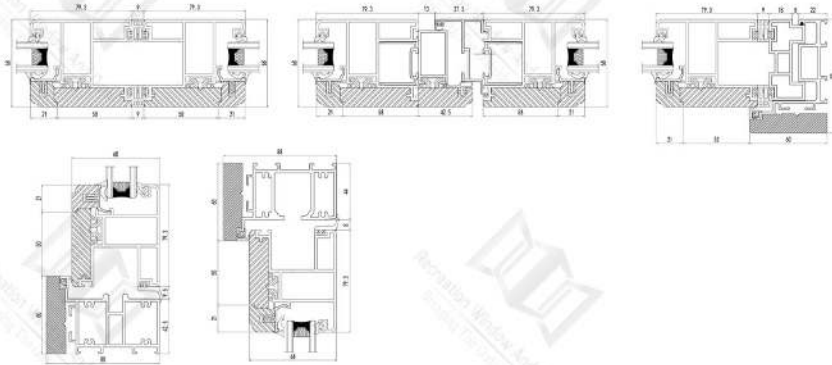

67

STANDARD FEATURES

- Operation:
 - Outward Opening: Bi-fold from multiple sashes
 - Possibility of a 90° corner sash without mullion
- Sections:
 - Frame: 88mm
 - Sash: 68mm
- Maximum dimensions/sash:
 - Width up to 1,000mm
 - Height up to 3,000mm
- Max weight/sash: 150 kg
- Multipoint locking hardware
- Maximum glazing thickness: 30mm



88 series

Aluminum wood folding door



68

PERFORMANCE

DESCRIPTION	VALUE	DESCRIPTION	VALUE
SHGC	0.14-0.97	U-Value (BTU/h·ft ² ·°F)	0.24-0.6
Air Infiltration (cfm/ft ²)	0.01	STC (dB)	45
Water resistance (psf)	12.11	VT	0.13-0.85

*Values may vary depending on glazing packages utilized

GENERAL SPECIFICATIONS

- Profile thickness: 2.0mm
- Double glazed glass
- Color powder coating

OPTIONS

- Multiple glazing packages and finish options
- Mosquito screens available
- Dual-sealed warm edge spacer
- Argon gas infill
- Optional solid wood material

68 series

Solid wood timber casement window & door

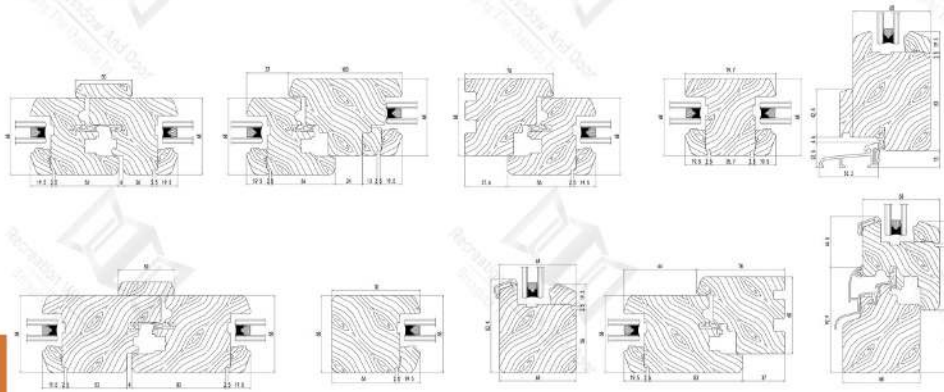

STANDARD FEATURES

- Opening: tilt and turn, side hung of 1 or 2 sashes
- Sections:
 - Frame: 68mm
 - Sash: 68mm
- Maximum dimensions/sash:
 - Width up to 1,500mm
 - Height up to 3,500mm
- Max weight/sash: 300 kg
- Multipoint locking hardware
- Maximum glazing thickness: 26mm



68 series

Solid wood timber casement window & door



PERFORMANCE

DESCRIPTION	VALUE	DESCRIPTION	VALUE
SHGC	0.14-0.97	U-Value (BTU/h·ft²·°F)	0.24-0.6
Air Infiltration (cfm/ft²)	0.01	STC (dB)	45
Water resistance (psf)	12.11	VT	0.13-0.85

*Values may vary depending on glazing packages utilized

GENERAL SPECIFICATIONS

- Double glazed glass
- Radius tops and arches available
- Optional color painted

OPTIONS

- Multiple glazing packages and finish options
- Mosquito screens available
- Dual-sealed warm edge spacer
- Argon gas infill
- Optional solid wood material

60 series

UPVC vinyl casement window & door

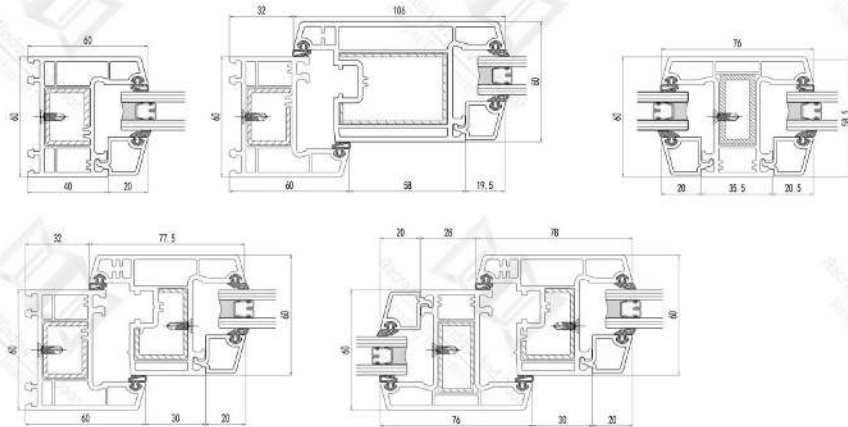

OPTIONS

- Multiple glazing packages and finish options
- Dual-sealed warm edge spacer

GENERAL SPECIFICATIONS

- profile thickness: 2.3mm - 2.5mm
- double glazed glass
- argon gas infill
- radius tops and arches available
- reinforce galvanized steel line: 1.2mm - 1.5mm
- color transfer printing
- optional mosquito screen

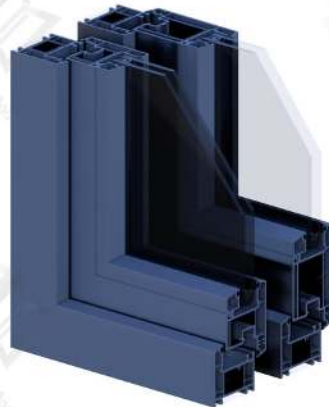

60 series

UPVC vinyl casement window & door



PERFORMANCE

DESCRIPTION	VALUE	DESCRIPTION	VALUE
SHGC	0.14-0.97	U-Value (BTU/h·ft ² ·°F)	0.24-0.6
Air Infiltration (cfm/ft ²)	0.01	STC (dB)	38
Water resistance (psf)	12.11	VT	0.13-0.85

*Values may vary depending on glazing packages utilized

STANDARD FEATURES

- Opening: side hung and top hung of 1 or 2 sashes
- Sections: - Frame: 60mm - Sash: 60mm
- Maximum dimensions/sash: - Width up to 1,000mm - Height up to 2,600mm
- Max weight/sash: 100 kg
- Multipoint locking hardware
- Maximum glazing thickness: 24mm

62 series

UPVC vinyl sliding window & door



STANDARD FEATURES

- Sliding of 2, 3, 4, 6 sashes
- Sections:
 - Frame: 62mm - Sash: 36mm
- Maximum dimensions/sash:
 - Width up to 1,500mm
 - Height up to 2,500mm
- Max weight/sash: 150 kg
- Multipoint locking hardware
- Maximum glazing thickness: 24mm

GENERAL SPECIFICATIONS

- Profile thickness: 2.3mm - 2.5mm
- Double glazed glass
- Color powder coating
- reinforce galvanized steel line: 1.2mm - 1.5mm



62 series

UPVC vinyl sliding window & door



PERFORMANCE

DESCRIPTION	VALUE	DESCRIPTION	VALUE
SHGC	0.14-0.97	U-Value (BTU/h-ft ² ·°F)	0.24-0.6
Air Infiltration (cfm/ft ²)	0.01	STC (dB)	35
Water resistance (psf)	12.11	VT	0.13-0.85

*Values may vary depending on glazing packages utilized

OPTIONS

- Multiple glazing packages and finish options
- Dual-sealed warm edge spacer
- argon gas infill
- Stainless steel wire mesh or nylon net

65 series

Thermal break aluminum pivot window

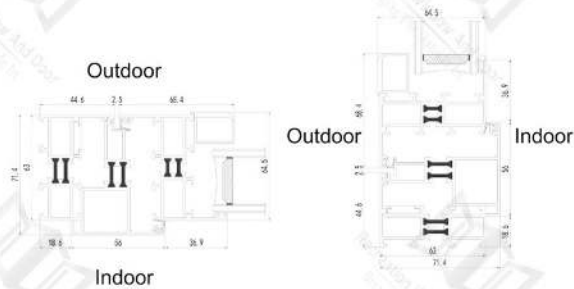

75

GENERAL SPECIFICATIONS

- profile thickness: 1.4mm
- double glazed glass
- argon gas infill
- Round , radius tops and arches available
- possibility of dual color
- color powder coating
- optional mosquito screen

OPTIONS

- Multiple glazing packages and finish options
- Dual-sealed warm edge spacer



65 series

Thermal break aluminum pivot window



76

PERFORMANCE

DESCRIPTION	VALUE	DESCRIPTION	VALUE
SHGC	0.14-0.97	U-Value (BTU/h-ft ² ·°F)	0.24-0.6
Air Infiltration (cfm/ft ²)	0.01	STC (dB)	41
Water resistance (psf)	12.11	VT	0.13-0.85

*Values may vary depending on glazing packages utilized

STANDARD FEATURES

- Opening: center pivot 1 sash
- Sections: - Frame: 65mm - Sash: 65mm
- Maximum dimensions/sash: - Width up to 1,600mm - Height up to 2,400mm
- Max weight/sash: 160 kg
- Multipoint locking hardware
- Maximum glazing thickness: 39mm

Recreation

Aluminum pivot door



Pivot Doors

Pivot doors make for a grand opening. The luxurious swing, combined with an up to 6 feet sash width make your home inviting and builds excitement to explore the home.

GENERAL SPECIFICATIONS

- Profile thickness: 2.0mm
- Double glazed glass
- Possibility of dual color
- Color powder coating

OPTIONS

- Multiple glazing packages and finish options
- Dual-sealed warm edge spacer
- argon gas infill

Recreation

Aluminum pivot door

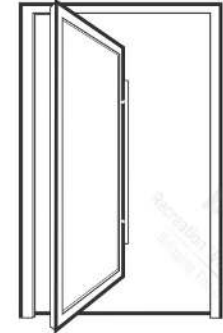

STANDARD FEATURES

- Sliding of 1 Sash
- Sections:
 - Frame: 100mm mm - Sash: 50mm
- Maximum dimensions/sash:
 - Width up to 2000mm
 - Height up to 3,500mm
- Max weight/sash: 300 kg
- Multipoint locking hardware
- Maximum glazing thickness: 28mm

Recreation

Aluminum or cladding wood facades & Curtain walls



With the allure of urban life only growing, designers and developers must find a way to accommodate an increasing population within the limits of existing cities. Space restrictions mean building up, not out, while still providing inviting and well-built condos, offices and commercial spaces. Curtain wall systems are a popular choice as they add design interest to architecture, as well as allow for maximum light within a building's space.

Recreation

Aluminum or cladding wood facades & Curtain walls



Features

- The possibility to achieve modern architecture of the building thanks to the shape of columns and pins that allows to build aesthetic facades with narrow dividing lines.
- High parameters of tightness and thermal insulation.
- Structure durability and resistance thanks to the high-quality aluminium profiles.
- Wide application options that allows to fulfill technically advanced expectations of investors, designers and architects.
- The possibility to make curtain walls in various shapes thanks to high static parameters of the profiles.
- variations of interior designs, thanks to a number of different glazing types, e.g. anti-reflective , safety glass.
- Wide range of RAL colours gives You freedom in shaping the facades.

Recreation

Aluminum awning skylight



81

GENERAL SPECIFICATIONS

- profile thickness: 2.0mm
- double glazed glass
- color powder coating
- China brand motor

OPTIONS

- Multiple glazing packages and finish options
- Mosquito screens available
- Dual-sealed warm edge spacer
- argon gas infill



Recreation

Aluminum sliding skylight



82

GENERAL SPECIFICATIONS

- profile thickness: 2.0mm
- double glazed glass
- color powder coating
- China brand motor

OPTIONS

- Multiple glazing packages and finish options
- Mosquito screens available
- Dual-sealed warm edge spacer
- argon gas infill



Recreation

Aluminum naco glass jalousie windows

Adjustable louvers are operational from fully open to fully closed for positive shut off of air intake or exhaust. Drainable adjustable louvers also give added protection against water penetration.



GENERAL SPECIFICATIONS

- profile thickness: 2.0mm
- 5mm single glazed tempered glass
- color powder coating
- adjustable ventilation

OPTIONS

- Mosquito screens available



Recreation

Aluminum adjustable shutter blade louver



GENERAL SPECIFICATIONS

- profile thickness: 1.6mm
- color powder coating

OPTIONS

- Mosquito screens available





PERGOLA & VERANDA

Embrace outdoor living the whole year round with our incredible remote-controlled, motorised pergola system which allows you to adjust the roof for solar shading, ventilation, illumination and rain protection depending on the season.

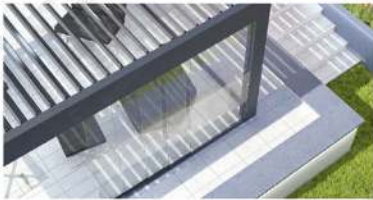

Cover your terrace and extend the living area of your home, or create a luxury space anywhere in your garden with its robust freestanding configuration.



better outdoor living...



Window & door

installation guide



Nail Fin Flush Fin Block Frame

Window-frame types: It's important to order the right window-frame type for the method of window installation you plan to use.

Installing Replacement Windows

The most important considerations for installing new windows is that the window installation is watertight and airtight. Water leakage deteriorates building components around the window. To prevent water leakage in frame buildings, the window must be integrated, if possible into the home's water resistive barrier (WRB).

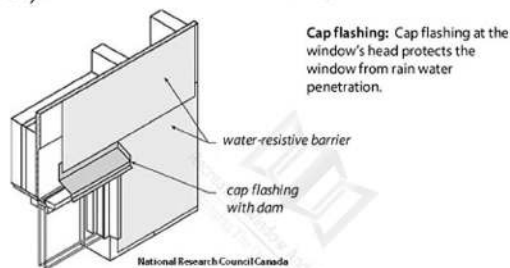

Replacing Nailing-Fin Windows

Install replacement windows with nailing fins in the rough opening after removing the existing window frame and exterior trim. Fasten the nailing fins directly to the house's sheathing or framing, but support the window's weight on the sill with or without shims before fastening the window to the building. Water-Resistive Barrier (WRB): Designers and builders assume that some rain water penetrates through the siding.

Window & door

installation guide

The WRB is the building's last defense against water. House wrap and asphalt felt are the most common WRBs. Window replacements that expose the home's WRB must incorporate the WRB in the window installation. Install a sill pan below the window and flashing on the side fins. Use flashing to connect the window opening to the WRB so water that penetrates the siding, trim, or window exits the building by way of the WRB.

Windows are exposed to wind and rain. Install replacement windows so water that penetrates the siding or trim drains to the outdoors. If water leaks underneath the existing WRB or the new flashing, the water eventually damages the building. With proper flashing, the fins and flashing create a drainage system that drains water to the outdoors rather than relying on caulked siding and trim to prevent rain water from penetrating the building's surface.

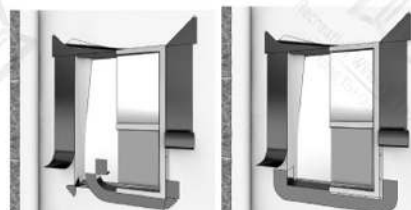

Flashing nail-fin windows: Installers place the window on and over the sill flashing. The side and top flashing cover the fastening fin. The two methods shown here are: using a flexible membrane (right) and using a bowtie-shaped flashing to underlay the corners when using a standard membrane.

Follow these steps to install a nailing-fin window in the rough opening.

1. At the sill, insert the flashing underneath the existing siding, over top of existing building paper, and under the bottom nailing fin of the window.

Window & door

installation guide

2. Use flat shims to provide a level surface and support under the vertical structural members of the new window frame. Don't allow the fins to support the window's weight.
3. Use fasteners with heads wide enough in diameter to span the holes or slots in the window fin.
4. Avoid over-driving the fasteners or otherwise deforming the window fin.
5. Flash the window around its perimeter with 15-pound felt, house wrap, or a peel-and-stick membrane.
 - a. Flashing procedures may vary. However, always install flashing materials to overlap like shingles.
 - b. Insert the new building paper or flashing underneath the existing siding and underneath existing building paper on the sides and top of the window opening.
6. Windows that are exposed to wind-driven rain or without overhangs above them or without WRB integration should have a rigid cap flashing (also called head flashing) to prevent rainwater from draining onto the window. The cap flashing should divert water away from vertical joints bordering the window with an overhang or dam.
7. Tuck the cap flashing up behind the WRB or exterior siding. Metal cap flashing must have downward bending lip of at least 1/4 inch on the front and ends.
8. Thoroughly caulk all filler and trim pieces surrounding the replacement window.

Window & door

installation guide

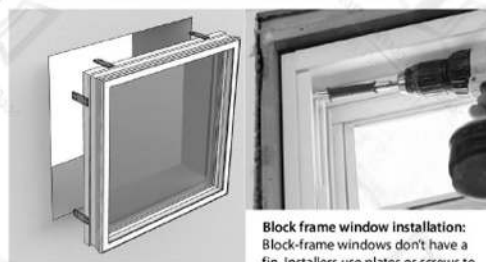

Block frame window installation: Block-frame windows don't have a fin. Installers use plates or screws to fasten the window to its opening.

Block-Frame or Finless Windows

Contractors install windows using a block-frame or finless installation when they can't remove the existing window frame or in a masonry window opening. Block-frame windows rely on caulk or rigid flashing to create a weatherproof seal around the window perimeter. Take care when installing caulk so that it is durable and effective for as long as possible.

Comply with the following requirements when installing block-frame or finless windows.

1. Block-frame or finless windows may require a sufficiently wide gap between the new window and the existing window frame or masonry opening to allow for the following.
 - a. Allowing for a slightly out-of-square opening.
 - b. Leveling the window.
 - c. Insulating the gap with foam.
2. Access the window-weight cavities, remove the weights, and fill the cavities with insulation, and seal the cavities.

Window & door

installation guide

3. Protect the existing sill with a metal or plastic sill pan or rigid sill flashing if necessary for drainage and to protect the existing sill that protrudes from the exterior wall. Or, install a new sill as part of the window replacement.
4. Support block-frame or finless windows under their main vertical supports with shims that level the window.
 - a. Use flat shims for support if the sill surface is flat.
 - b. Use tapered shims or a sill angle for support if the sill surface is sloping.
5. Windows without fins must be secured to the rough opening within 4 inches of each side corner and a minimum 12 inches on center along the remainder of the frame with one of these fastening methods.
 - a. Screws fastened through the window frame. Use screws that are designed for fastening block-frame windows if available.
 - b. Jamb clips or plates that are fastened first to the window and then to the opening in separate steps.
6. Fill any gaps over $\frac{3}{8}$ inch that are between the exterior siding and the block-frame window. Install backer rod in all exterior or interior voids over $\frac{3}{8}$ inch in depth or width before caulking.
7. If possible, flash block-frame windows between the opening and the replacement-window frame and extend the flashing out far enough to slip under or into the siding.
 - a. Tuck the flashing up behind the exterior siding at least 1 inch.
 - b. Sill and cap flashing should have a downward bending lip of at least $\frac{1}{4}$ inch on the front that sheds water away from the building.

Window & door

installation guide

Flush-Fin Window Replacement

Flush-frame windows are replacement windows that fasten to the window opening and mount directly over the flat siding surrounding the window opening. Replace windows in stucco walls using windows with flush fins, also called stucco fins, that have no nail holes. Flush-fin windows work well for any window opening with a flat water-resistant finished surface surrounding the window opening. This flush-fin window-replacement technique is similar to block-frame window installation.

1. Support the replacement window on the existing sill with one of the following materials.
 - a. A flat or tapered continuous wood support.
 - b. Flat shims under the window's main vertical supports.
 - c. Tapered shims under the window's main vertical supports if the sill is sloping.
2. Apply a sealant that remains flexible to the back of the flush fin of the replacement window in order to seal it to the surface of the exterior wall. Interrupt the caulking at the bottom fin for one inch on each side of the window's weep holes.
3. Fasten the flush-fin window to the window opening by driving screws through the replacement window's frame.



Flush frame window: Flush frame windows have the fin at the exterior surface of the window and seal to a flat exterior surface like stucco.

Energy Efficient

Recreation Window & Door

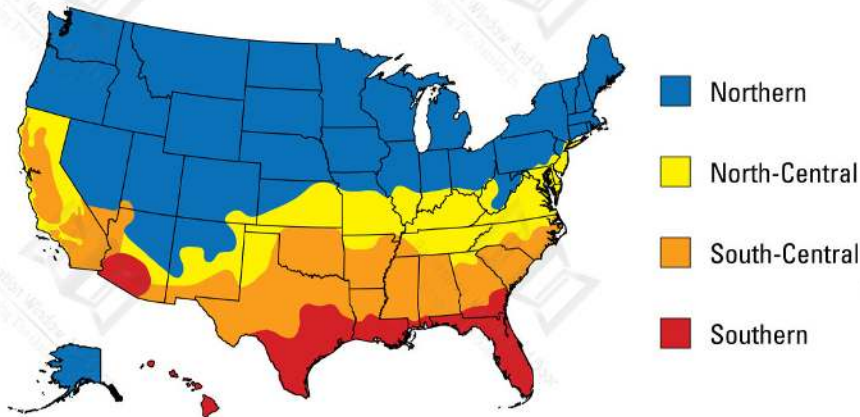

DOORS			
GLAZING LEVEL	U-FACTOR ¹	SHGC ²	
Opaque	≤ 0.17	No Rating	
≤ ½-Lite	≤ 0.25	≤ 0.25	
> ½-Lite	≤ 0.30	Northern North-Central	≤ 0.40
		Southern South-Central	≤ 0.25

Air Leakage for Sliding Doors ≤ 0.3 cfm/ft²
 Air Leakage for Swinging Doors ≤ 0.5 cfm/ft²

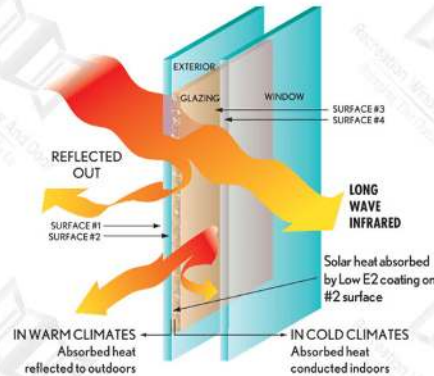

Energy Efficient

Recreation Window & Door

WINDOWS			
CLIMATE ZONE	U-FACTOR ¹	SHGC ²	
Northern	≤ 0.27	Any	
	≤ 0.28	≥ 0.32	
	≤ 0.29	≥ 0.37	
	≤ 0.30	≥ 0.42	
North Central	≤ 0.30	≤ 0.40	
South Central	≤ 0.30	≤ 0.25	
Southern	≤ 0.40	≤ 0.25	

SKYLIGHTS			
CLIMATE ZONE	U-FACTOR ¹	SHGC ²	
Northern	≤ 0.50	Any	
North Central	≤ 0.53	≤ 0.35	
South Central	≤ 0.53	≤ 0.28	
Southern	≤ 0.60	≤ 0.28	

Air Leakage ≤ 0.3 cfm/ft²
¹ Btu/h ft²°F
² Solar Heat Gain Coefficient

Does my window need to be ENERGY STAR certified in order to be energy efficient?

No. While an ENERGY STAR label can be helpful in identifying energy-efficient windows, every home is unique. ENERGY STAR provides a one-size-fits-all guideline but does not take into consideration, for example, the orientation of the house or the number or size of windows and associated Solar Heat Gain. A window expert like your Marvin dealer can help determine which products will work best for you. ENERGY STAR also recognizes products that meet high energy-efficiency guidelines. PUERTANA offers the industry's widest selection of wood and clad wood products that meet these rigorous criteria.

Glass options

Product designs



Choosing the right glass options for your project can help ensure you're investing your money wisely in a glass package that will give you the energy efficiency your home and climate requires. Choose from a variety of insulating options, including standard dual or optional triple pane insulated glass options and surface coatings that help manage the amount of light and heat entering and leaving your home. Understanding your glass options helps ensure you're paying for the efficiency you need without selecting options that may not offer return over time.

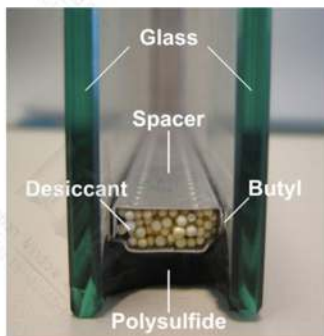

Glass options

Product designs

Dual Pane

Our standard glazing is dual pane: two panes of glass with Low E coatings and insulated with argon gas. Compared to a single glass pane, dual pane glass cuts energy costs significantly because of low emissivity coating and the gas filled insulating space between the glass layers.

Triple Pane

Triple pane glazing consists of three panes of glass with Low E coatings applied to the surface. Two glass spaces are insulated with argon gas between the panes

Is Triple Pane Right for You?

Triple pane doesn't necessarily mean a window is more energy efficient. Glass coatings, the type of gas used in the spaces between the glass, the design of the window, the materials used, and how well it is installed all play a role in achieving the overall energy efficiency. Consider the energy efficiency of the entire window not just the number of panes of glass it has.

Is Triple Pane Right for You?

Low E coatings are microscopically thin, essentially invisible coatings on the glass surface that help manage the amount of light and heat conducted through a window pane or reflected away from it, reducing a home's dependence on heat and air conditioning. The national ENERGY STAR® program recognizes products that meet strict energy-efficiency guidelines to suit climates in different areas of the country, and PUERTANA offers products to meet climate and code requirements in every region.

Glass options

Product designs

Low E1

Low E1 coating is a good choice when you want maximum solar heat gain (or maximum heat transferring into your house from the sun) and radiant heating properties (keeping heat on the side of the glass where it originated). This type of coating is generally used in Northern climates where heating is prioritized over cooling. You'll reap maximum benefits when windows with this type of coating are positioned to receive direct sun exposure.

Low E2

The most common Low E coating since it works well across most geographic regions and climates. Low E2 with two metallic coatings balances less solar heat gain and improved radiant heating properties.

Low E3

Used in applications where solar heat gain may be a concern, low E3 coating uses multiple metallic layers for radiant properties similar to Low E2. This type of coating is most commonly used in Southern, sunny climates where cooling is prioritized over heating.

Low ERS

A higher performing Low E glass with significantly improved U Factors (ability to keep heat inside of your home). This coating is placed on the interior surface of the glass and can be touched. It is used in conjunction with Low E2 or Low E3 and helps reflect radiant heat back into the room. This means a slightly cooler interior glass surface since the heat is not absorbed by the glass. The cooler surface may see a bit more condensation in cold climates versus traditional Low E glass make-ups. Abrasive products should be avoided when cleaning the glass.

Glass options

Product designs

Decorative Glass

A variety of decorative glass options are available to meet the unique needs of each project. Laminated glass is also available in clear, bronze, gray, or green with tinted interlayers.



Bronze Tint



Gray Tint



Green Tint



White Laminated



Aqualite



Beveled



Flemish



Frost

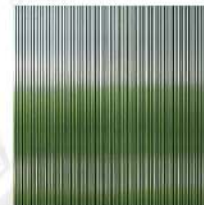

Narrow Reed



Obscure



Rain



Reed



Recreation Window and Door
Bringing The Outside In

Recreation Window and Door

Recreationwindowanddoor@gmail.com | Recreationwindowanddoor.com

BE INSPIRED!

